

MARADYNE[®]

HIGH PERFORMANCE FANS

Manufacturing quality fans for over 20 years!

PRODUCT CATALOG

Volume 15



WHO WE ARE

DCM • FAZ
GRAND PRAIRIE, TEXAS
SALES
ENGINEERING
PRODUCT DEVELOPMENT
TESTING
DISTRIBUTION

DCM • FAZ
CLEVELAND, OHIO
CORPORATE
SALES
DISTRIBUTION

DCM • FAZ
EMPALME, MEXICO
MANUFACTURING
DISTRIBUTION

DCM • FAZ
IZMIR, TURKEY
SALES
ENGINEERING
PRODUCT DEVELOPMENT
TESTING
MANUFACTURING
DISTRIBUTION

A strong family-operated business . . .

MARADYNE® High Performance Fans is a brand name owned by **DCM • FAZ**, a wholly-owned subsidiary of **Dreison International, Inc.** **DCM • FAZ** manufactures and sells accessories and components serving the off-road equipment, agricultural machinery, heavy-duty truck, automotive, bus, recreational vehicle, marine and military markets.

DCM • FAZ facilities are located in Cleveland, OH, Grand Prairie, TX, Shenzhen, China, Empalme, Mexico and Izmir, Turkey. **DCM • FAZ** also maintains strategic manufacturing alliances throughout China. Every facility is supported by our team of engineers in the United States and Turkey as well as **DCM • FAZ** employees in Asia and Mexico. All of our products are produced to meet USA design specifications by our engineers, using quality components and built in our facilities.

DREISON INTERNATIONAL INC.

DCM • FAZ

DCM • FAZ

DC Brushed & BLDC Motors, Axial Fans, Centrifugal Blowers,
Louvers & Accessories

DCM Bus PARTS

Bus Parts & Accessories

MARADYNE® HIGH PERFORMANCE FANS

Fans, Heaters & Accessories

MARADYNE® MARINE PRODUCTS

Marine Heaters, Fans & Accessories

MARADYNE® MOBILE PRODUCTS

Heaters, Blowers, Motors, DashMount fans & Service Parts

MARADYNE® CORPORATION

TURBO® PRECLEANERS

Precleaners for Heavy Duty Machinery

POW-R-QUIK STARTERS

Turbo, Vane & Hydraulic Starters

GREENLEES FILTER

Air Cleaners & Filter Elements

MARADYNE® FLUID POWER

Filtration for Hydraulic Systems

INNOVATIVE DEHUMIDIFIER

Moisture Removal Solutions

These companies are operated by the Berger family, which has taken an active role in their management for 40 years and has focused on providing quality products and premier service.

Dreison International, Inc. currently employs approximately five hundred people, and annual revenues are approximately seventy five million U.S. dollars. The philosophy to produce and distribute a quality product at a fair price, backed with service is a family tradition that ensures continual growth.

THINGS TO KNOW

At MARADYNE®

We design only the highest quality components into our fan assemblies. All plastic components are molded from engineering grade glass-filled nylon resin. All motors are designed for long life, high durability and use in harsh environments. These motors perform exceptionally well on the track and in extreme off-road conditions. All fan products are performance tested using our in-house air test chamber which insures you can trust our performance numbers.

MARADYNE® engineering also controls and monitors the design and manufacture of our fan assemblies at every step of the process, insuring you get a quality product every time. **MARADYNE®** Engineering strives to improve upon existing industry accepted designs so you get the best fan for your buck.

MARADYNE® fans are found on NASCAR cars & trucks, dragsters, hot rods, off-road vehicles, mobile generator sets, military vehicles, buses, golf carts, and many other specialty applications.

Why Buy a MARADYNE® High Performance Fan

- **INCREASED ENGINE COOLING** – Electric fans offer maximum performance at engine idle (when you need it most). Engine-driven fans are at their lowest rpm at idle.
- **INCREASED HORSE POWER** – Removing an engine-driven fan can increase horsepower as the engine drag from turning the fan is eliminated.
- **INCREASED MPG** – Removing an engine-driven fan can increase gas mileage as well, as the engine drag from turning the fan is eliminated.
- **INCREASED A/C COOLING AT IDLE** – Have you ever had your A/C blow warmer at a stop light? With the compressor turning slower at idle, increased airflow across the A/C condenser can help with colder A/C at idle.
- **CONCENTRIC RINGS** – Larger **MARADYNE®** fans have rings that prevent the blades from flexing as they achieve maximum rpm. These rings keep the blades properly pitched for maximum airflow.
- **SEALED MOTORS** – On Champion, Mach and Jetstreme Series fans, the sealed motors are waterproof and dustproof to IP68 making them excellent for off-road applications where sand, dust or water can enter the engine compartment.
- **DYNAMICALLY BALANCED** – All **MARADYNE®** fans are dynamically balanced at the factory with balancing clips just as you balance a tire to a wheel. This provides for smooth running, less noise and longer life for the motor.
- **NATIONWIDE AND CUP SERIES PROVEN** – Our flagship fan, the 16" Champion Series M162K, is not only our most popular fan, it is the same fan we sponsor several NASCAR Cup, Xfinity and Camping World Truck Series teams with. These teams value the fans as much for its ability to survive high speeds as for its performance. If it can cool an 800 hp 358 c.i. engine, it will likely cool your favorite ride. Most of our competition can not make this claim.

How to Choose an Electric Cooling Fan

What to consider when choosing the proper Maradyne High Performance Electric Cooling Fan? **MARADYNE® High Performance Fans** are considered universal fit electric fans so there are a couple different model fans that may fit any one application.

First: Start with measuring the core size of the radiator, just the core do not include the measurements of the cooling tanks on each side or top and bottom of the radiator. This will give you an idea of what diameter fan can be used or what shrouded version fans can be used. (Note: fans must cover as much of the radiator as possible. Fabricating or purchasing a shroud may be necessary).

Second: Consider all aspects of the engine, if you are dealing with a stock to mildly upgraded engine you do not need a fan with a high wattage motor or highest rated cfm but if you are dealing with a mid to highly upgraded engine you will want to consider the fans that have a higher wattage motor with maximum cfm of air movement. Fan motor wattage can range from 90w to 225w in the 12v configuration. If your application is mild now but plan to upgrade it there is nothing wrong with using the higher cfm rated fans as the fan is controlled by the temperature sending unit.

Push vs. Pull: If you are working with space issues keep in mind certain model fans can be reversible so they can either pull the air or push the air through the radiator. For example, in the majority of automotive applications fans are set up in the puller configuration to pull the air through the radiator from the grille opening area; however due to space issues & airflow characteristics, the need to mount the fan in the pusher configuration to push the air from the grille area through the radiator may be necessary.

Wattage: Note the more powerful cfm fan or fans you may choose the more amp draw it will have so make sure your electrical system can handle the addition of an electric fan. Amp draws on 12 to 16 inch fans can range from 15 to 28 amps, some dual fan applications can draw up to 35 amps.

SPONSORSHIPS

Proud **CHAMPION** SERIES Cooling Fan Sponsor of . . .



TABLE OF CONTENTS

Who We Are	2
<i>A strong family-operated business</i>	2
Things to Know	3
At MARADYNE®	3
Why Buy a MARADYNE® High Performance Fan	3
How to Choose an Electric Cooling Fan	3
Sponsorships	4
Venturini Motorsports GTF Motorsports Premium Motorsports Furr Racing Too Fast Racing Staruiala Racing Association	4
Table of Contents	5
New Product	6
Smart Start Fans	6
High Performance Fans	7 – 15
Jetstreme Platinum Supreme (seen on cover)	7
Jetstreme Series (Jetstreme I Jetstreme II Jetstreme II Platinum)	8 & 9
Champion Series (Low Profile High Profile Ultra Thin)	10 & 11
Mach Series (Mach One Mach Two Mach Two Extreme)	12 & 13
Challenger Series	14
Pacesetter Series	15
Fan Accessories	16 – 17
Hydronic Heaters	18 – 27
Stoker™ Heater Series (9" Stoker Heaters 16" Stoker Heater)	18 – 20
Carlsbad Heater	21
Durango Heater	22
Havasu Heater	23
Sedona Heater	24
Sonora Heater	25
Santa Fe Heater	26
The Heat 5000 Heater	27
Heater Accessories	28 – 29
Specialty Items	30
Texas Twister (Fan Blades) Junior Jet 150 Cool Cat Dash Fan	30
Part # Index	31

NEW PRODUCT

SMART START FANS



- Provides Features Of Brushless BLDC Fans.
- Minimized Amperage Draw At Start Up.
- Lower Cost Than BLDC Fans.
- No PWM Controller Required.
- Smooth & Uniform Starting.
- Limits Transient Voltage.
- Reduces Strain On The Fuse.
- Reduces Strain On The Motor.
- Extends Life Of The Fan.



MSS162K

16" Puller S-Blade



MSS12K

Shrouded 12" Puller S-Blade



MSS22K

Shrouded Dual 12" Puller S-Blade

SMART START FANS SERIES SPECIFICATIONS

PART #	FAN	BLADE	DIRECTION	MOTOR	WIDTH x HEIGHT x DEPTH	CFM @ 0"	AMPS
<i>Smart Start Fans</i>							
MSS162K	16" Low Profile	S-Blade	Puller	LL ⁵ 225W Heavy Duty	3.37" (Depth)	2,170	18.0
MSS166K	16" Low Profile	S-Blade	Puller	LL ⁵ 160W Heavy Duty	3.02" (Depth)	1,810	12.3
<i>Smart Start Shrouded Fans</i>							
MSS12K	12" Shrouded	S-Blade	Puller	LL ⁵ 225W Heavy Duty	13.5" x 15" x 4.02"	1,700	14.7
MSS16K	12" Shrouded	S-Blade	Puller	LL ⁵ 160W Heavy Duty	13.5" x 15" x 3.70"	1,300	12.4
<i>Smart Start Shrouded Dual Fans</i>							
MSS22K	Dual 12" Shrouded	S-Blade	Puller	(2) LL ⁵ 225W Heavy Duty	26" x 15" x 4.02"	3,400	28.5
MSS26K	Dual 12" Shrouded	S-Blade	Puller	(2) LL ⁵ 160W Heavy Duty	26" x 15" x 3.70"	2,600	24.8

1 Fan accessories sold separately (except where noted). See pages 16 & 17 for accessory descriptions.

HIGH PERFORMANCE FANS

JESTREME SINGLE AND DUAL SHROUDED FANS

PROPRIETARY SICKLE BLADE DESIGN

Works as a Puller

INCREASED AIRFLOW

Rubber Seal Eliminates Vibration and Increases Airflow

INDUSTRY LEADING PERFORMANCE

Dynamically Balanced to Provide Smooth Performance & Low Noise

LONG LIFE MOTOR

Waterproof & Dustproof (IP68) for Extreme Environments

SUPERIOR QUALITY

Long Life Limited 3 Year Warranty



MJS12KPS

Shrouded 12" Puller
"NEW" Proprietary S-Blade



MJS22KPS³

Shrouded Dual 12" Puller
"NEW" Proprietary S-Blade

See Pages 8 & 9 for
Jestreme Accessories & Harnesses¹

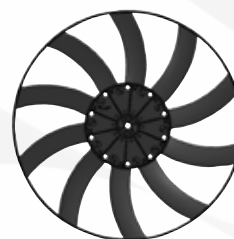

S-BLADE

Jetstreme & Platinum



SICKLE BLADE⁴

Platinum Supreme

JETSTREME PLATINUM SUPREME SERIES SPECIFICATIONS

PART #	FAN	BLADE	DIRECTION	MOTOR	WIDTH x HEIGHT x DEPTH	CFM @ 0"	AMPS
Jetstreme I Platinum Supreme							
MJS12KPS	12" Shrouded	"NEW" Sickle Blade ⁴	Puller	LL ⁵ 225W Heavy Duty	13.5" x 15" x 4.02"	1,700	14.7
MJS12KPSC ²	12" Shrouded	"NEW" Sickle Blade ⁴	Puller	LL ⁵ 225W Heavy Duty	13.5" x 15" x 4.02"	1,700	14.7
Jetstreme II Platinum Supreme							
MJS22KPS	Dual 12" Shrouded	"NEW" Sickle Blade ⁴	Puller	(2) LL ⁵ 225W Heavy Duty	26" x 15" x 4.02"	3,400	28.5
MJS22KPSC ²	Dual 12" Shrouded	"NEW" Sickle Blade ⁴	Puller	(2) LL ⁵ 225W Heavy Duty	26" x 15" x 4.02"	3,400	28.5

¹ Fan accessories sold separately (except where noted). See pages 16 & 17 for accessory descriptions.

² Adjustable thermostat MFA100 Included with all KPSC models.

³ Dual fan adapter MFA111 needed for Jetstreme II wire harnesses.

⁴ New Proprietary Sickle Blade.

⁵ LL stands for Long Life motor.

HIGH PERFORMANCE FANS



JESTREME SINGLE AND DUAL SHROUDED FANS

QUIET S-BLADE DESIGN

Works as a Puller

INCREASED AIRFLOW

Rubber Seal Eliminates Vibration and Increases Airflow

INDUSTRY LEADING PERFORMANCE

Dynamically Balanced to Provide Smooth Performance & Low Noise

LONG LIFE MOTOR

Waterproof & Dustproof (IP68) for Extreme Environments

SUPERIOR QUALITY

Long Life Limited 3 Year Warranty



MJS16K

Shrouded 12" Puller S-Blade

WIRE HARNESSES¹

MFA100² (adjustable thermostat)

MFA101 (A/C relay)

MFA102 (185° temperature switch)

MFA103 (195° temperature switch)

MFA111³ (dual fan adapter)

MOUNTING BRACKETS¹

MFA107⁴ (mounting brackets)



MFA100²

Harness w/Adjustable Temperature Switch & Relay



MFA111³

Dual Fan Adapter



MFA107⁴

Jetstreme Series Mounting Brackets



MJS13K

Shrouded 12" Puller S-Blade



HIGH PERFORMANCE FANS



MJS22K

Shrouded Dual 12" Puller S-Blade

MJS26K

Shrouded Dual 12" Puller S-Blade

Long Life
Motor

See Pages 7 for "NEW"
Jestreme Platinum Supreme



MJS23K

Shrouded Dual 12" Puller S-Blade

JETSTREME SERIES SPECIFICATIONS

PART #	FAN	BLADE	DIRECTION	MOTOR	WIDTH x HEIGHT x DEPTH	CFM @ 0"	AMPS
Jetstreme I (PAGE 8)							
MJS16K	12" Shrouded	S-Blade	Puller	LL ⁵ 160W Heavy Duty	13.5" x 15" x 3.70"	1,300	12.4
MJS16KC ²	12" Shrouded	S-Blade	Puller	LL ⁵ 160W Heavy Duty	13.5" x 15" x 3.70"	1,300	12.4
MJS13K	12" Shrouded	S-Blade	Puller	LL ⁵ 130W Heavy Duty	13.5" x 15" x 3.31"	1,155	7.2
MJS13KC ²	12" Shrouded	S-Blade	Puller	LL ⁵ 130W Heavy Duty	13.5" x 15" x 3.31"	1,155	7.2
Jetstreme II (PAGE 9)							
MJS26K	Dual 12" Shrouded	S-Blade	Puller	(2) LL ⁵ 160W Heavy Duty	26" x 15" x 3.70"	2,600	24.8
MJS26KC ²	Dual 12" Shrouded	S-Blade	Puller	(2) LL ⁵ 160W Heavy Duty	26" x 15" x 3.70"	2,600	24.8
MJS23K	Dual 12" Shrouded	S-Blade	Puller	(2) LL ⁵ 130W Heavy Duty	26" x 15" x 3.31"	2,310	14.4
MJS23KC ²	Dual 12" Shrouded	S-Blade	Puller	(2) LL ⁵ 130W Heavy Duty	26" x 15" x 3.31"	2,310	14.4
Jetstreme II Platinum (PAGE 9)							
MJS22K	Dual 12" Shrouded	S-Blade	Puller	(2) LL ⁵ 225W Heavy Duty	26" x 15" x 4.02"	3,100	26.6
MJS22KC ²	Dual 12" Shrouded	S-Blade	Puller	(2) LL ⁵ 225W Heavy Duty	26" x 15" x 4.02"	3,100	26.6

1 Fan accessories sold separately (except where noted). See pages 16 & 17 for accessory descriptions.

2 Adjustable thermostat MFA100 Included with all KC models.

3 Dual fan adapter MFA111 needed for Jetstreme II wire harnesses.

4 Mounting brackets MFA107 are included with all Jetstreme Series fans.

5 LL stands for Long Life motor.

HIGH PERFORMANCE FANS



M162K

16" Reversible S-Blade



M142K

14" Reversible S-Blade



M122K

12" Reversible S-Blade



M083K

8" Reversible S-Blade



M103K

10" Reversible S-Blade



M059K

5" Puller Only Straight Blade

CHAMPION LOW PROFILE FANS

Lowest Profile **High Performance** on the Market

QUIET S-BLADE DESIGN

Works as a Pusher or a Puller as Needed in Application

INDUSTRY LEADING PERFORMANCE

Dynamically Balanced to Provide Smooth Performance & Low Noise

LONG LIFE MOTOR

Limited 3 Year Warranty

SUPERIOR QUALITY

Waterproof & Dustproof (IP68) for Extreme Environments

INCLUDES

Locking Mating Pigtail Connector

WIRE HARNESSES¹

- MFA100** (adjustable thermostat)
- MFA101** (A/C relay)
- MFA102** (185° temperature switch)
- MFA103** (195° temperature switch)

MOUNTING BRACKETS¹

- MFA104** (metal bracket strips)
- MFA105** (aluminum brackets)



MFA113³

Fan Pigtail Connector



HIGH PERFORMANCE FANS

CHAMPION HIGH PROFILE FANS

POWERFUL WIDE STRAIGHT BLADE

Works as Puller Only



TA11A3001

11" Straight Blade Puller



TA12A3001

12" Straight Blade Puller

CHAMPION ULTRA THIN FANS

QUIET STRAIGHT BLADE DESIGN

Works as a Puller Only



M143K

14" Straight Blade Puller



M163K

16" Straight Blade Puller

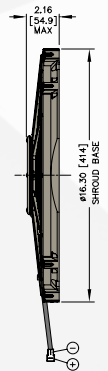

Fits into the tightest spaces!

CHAMPION SERIES SPECIFICATIONS

PART #	FAN	BLADE	DIRECTION	MOTOR	DEPTH	CFM @ 0"	AMPS
<i>Champion Low Profile (PAGE 10)</i>							
M162K	16" Low Profile	S-Blade	Reversible	LL ⁵ 225W Heavy Duty	3.37"	2,170	18.0
M142K	14" Low Profile	S-Blade	Reversible	LL ⁵ 225W Heavy Duty	3.37"	2,135	17.2
M122K	12" Low Profile	S-Blade	Reversible	LL ⁵ 225W Heavy Duty	3.37"	1,595	18.3
M166K	16" Low Profile	S-Blade	Reversible	LL ⁵ 160W Heavy Duty	3.02"	1,810	12.3
M146K	14" Low Profile	S-Blade	Reversible	LL ⁵ 160W Heavy Duty	3.02"	1,555	10.1
M123K	12" Low Profile	S-Blade	Reversible	LL ⁵ 130W Heavy Duty	2.62"	1,155	7.7
M113K	11" Low Profile	S-Blade	Reversible	LL ⁵ 130W Heavy Duty	2.62"	1,110	7.4
M103K	10" Low Profile	S-Blade	Reversible	LL ⁵ 130W Heavy Duty	2.62"	950	7.9
M093K	9" Low Profile	S-Blade	Reversible	LL ⁵ 130W Heavy Duty	2.62"	790	7.7
M083K	8" Low Profile	S-Blade	Reversible	LL ⁵ 130W Heavy Duty	2.62"	450	8.1
M073K	7" Low Profile	S-Blade	Reversible	LL ⁵ 130W Heavy Duty	2.62"	375	6.5
M059K ²	5.2" Low Profile	Straight Blade	Puller	30W Medium Duty	2.48"	315	3.8
<i>Champion High Profile (PAGE 11)</i>							
TA12A3001 ⁴	12" Low Profile	Wide Straight Blade	Puller	LL ⁵ 225W Heavy Duty	3.27"	1,795	15.2
TA11A3001 ⁴	11" Low Profile	Wide Straight Blade	Puller	LL ⁵ 225W Heavy Duty	3.31"	1,455	11.9
<i>Champion Ultra Thin (PAGE 11)</i>							
M163K	16" Low Profile	Straight Blade	Puller	LL ⁵ 130W Heavy Duty	2.52"	1,408	8.5
M143K	14" Low Profile	Straight Blade	Puller	LL ⁵ 130W Heavy Duty	2.52"	1,163	6.4

1 Fan accessories sold separately (except where noted). See pages 16 & 17 for accessory descriptions.

2 5" fan M059K motor does NOT meet IP68 requirements (molded in mounting feet) (separate mounting feet not needed).

3 Fan pigtail MFA113 is included with all Champion Series fans.

4 Mounting brackets are not used on High Profile Series (molded in mounting feet) (separate mounting feet not needed).

5 LL stands for Long Life motor.

HIGH PERFORMANCE FANS



MM12K

Shrouded 16" Pusher S-Blade



MACH SHROUDED FANS

INCREASED AIRFLOW

Rubber Seal Eliminates Vibration and Increases Airflow

INDUSTRY LEADING PERFORMANCE

Dynamically Balanced to Provide Smooth Performance & Low Noise

LONG LIFE MOTOR

Waterproof & Dustproof (IP68) for Extreme Environments

SUPERIOR QUALITY

Long Life Limited 3 Year Warranty

WIRE HARNESES¹

MFA100² (adjustable thermostat)

MFA101 (A/C relay)

MFA102 (185° temperature switch)

MFA103 (195° temperature switch)

MFA111³ (dual fan adapter)

MOUNTING BRACKETS¹

MFA138 (Mach Two only)



MFA100²

Harness w/Adjustable Temperature Switch & Relay



MFA111³

Dual Fan Adapter



MM22KX

Shrouded Dual 16" Pusher S-Blade

Made for 34" Wide Radiator Cores



HIGH PERFORMANCE FANS

MACH ONE FAN & MACH TWO EXTREME DUAL FAN

QUIET S-BLADE DESIGN

MM12K, MM12KC & MM22KX

MACH TWO DUAL SHROUDED FANS

POWERFUL WIDE STRAIGHT BLADE

MM22K, MM22KS & MM22KT

MACH TWO



MM22K

Shrouded Dual 11"
Puller Straight Blade



MM22KS

MM22K w/Side Mount
For Top & Bottom Tank Radiators



MM22KT

MM22K w/Top & Bottom Mount
For Crossflow Radiators

MACH SERIES SPECIFICATIONS

PART #	FAN	BLADE	DIRECTION	MOTOR	WIDTH x HEIGHT x DEPTH	CFM @ 0"	AMPS
MACH ONE (PAGE 12)							
MM12K	16" Shrouded	S-Blade	Pusher	LL ⁴ 225W Heavy Duty	16" x 17" x 3.94"	2,160	18.0
MM12KC ²	16" Shrouded	S-Blade	Pusher	LL ⁴ 225W Heavy Duty	16" x 17" x 3.94"	2,160	18.0
MACH TWO (PAGE 13)							
MM22K	Dual 11" Shrouded	Wide Straight Blade	Puller	(2) LL ⁴ 225W Heavy Duty	23.5" x 15.75" x 3.35"	2,910	27.8
MM22KS	Dual 11" Shrouded	Wide Straight Blade	Puller	(2) LL ⁴ 225W Heavy Duty	26.5" x 15.75" x 3.35"	2,910	27.8
MM22KT	Dual 11" Shrouded	Wide Straight Blade	Puller	(2) LL ⁴ 225W Heavy Duty	23.5" x 18.25" x 3.35"	2,910	27.8
MACH TWO EXTREME (PAGE 12)							
MM22KX	Dual 16" Shrouded	S-Blade	Pusher	(2) LL ⁴ 225W Heavy Duty	33.5" x 17" x 3.57"	4,320	35.4

1 Fan accessories sold separately (except where noted). See pages 16 & 17 for accessory descriptions.

2 Adjustable thermostat MFA100 included with MM12KC

3 Dual fan adapter MFA111 needed for MACH TWO wire harnesses (included with MM22KX).

4 LL stands for Long Life motor.

HIGH PERFORMANCE FANS

CHALLENGER SERIES



MC162K
16" Reversible S-Blade



MC136K
13" Reversible S-Blade



MC119K
11" Reversible S-Blade



MC109K
10" Reversible S-Blade

ECONOMICAL

Good for **High Performance** or Daily Drivers

QUIET S-BLADE DESIGN

Works as a Pusher or a Puller as Needed in Application

INDUSTRY LEADING PERFORMANCE

Dynamically Balanced to Provide Smooth Performance & Low Noise

NON-VENTED MOTOR

Heavy Duty (90W Motors are Medium Duty)

SUPERIOR QUALITY

Limited Warranty

INCLUDES

Locking Mating Pigtail Connector and Mounting Feet

WIRE HARNESSES¹

MFA100 (adjustable thermostat)
MFA101 (A/C relay)
MFA102 (185° temperature switch)
MFA103 (195° temperature switch)

MOUNTING BRACKETS¹

MFA104 (metal bracket strips)
MFA105 (aluminum brackets)

UNIVERSAL WHITE BOX NON-BRANDED

CHALLENGER SERIES SPECIFICATIONS

PART #	FAN	BLADE	DIRECTION	MOTOR	DEPTH	CFM @ 0"	AMPS
MC162K	16" Medium Profile	S-Blade	Reversible	225W Heavy Duty	4.35"	2,200	18.9
MC166K	16" Medium Profile	S-Blade	Reversible	160W Heavy Duty	3.87"	1,950	13.1
MC136K	13" Low Profile	S-Blade	Reversible	160W Heavy Duty	3.82"	1,560	13.0
MC119K	11" Low Profile	S-Blade	Reversible	90W Medium Duty	2.62"	767	7.7
MC109K	10" Low Profile	S-Blade	Reversible	90W Medium Duty	2.62"	621	5.1

¹ Fan accessories sold separately (except where noted). See pages 16 & 17 for accessory descriptions.

HIGH PERFORMANCE FANS

ECONOMICAL

Good for **High Performance** or Daily Drivers

QUIET S-BLADE DESIGN

Works as a Pusher or a Puller as Needed in Application (MP089K & MP099K are Straight Blade)

INDUSTRY LEADING PERFORMANCE

Dynamically Balanced to Provide Smooth Performance & Low Noise

NON-VENTED MOTOR

Heavy Duty (90W Motors are Medium Duty)

SUPERIOR QUALITY

Limited Warranty

INCLUDES

Locking Mating Pigtail Connector and Mounting Feet

WIRE HARNESSES¹

MFA100 (adjustable thermostat)
MFA101 (A/C relay)
MFA102 (185° temperature switch)
MFA103 (195° temperature switch)

MOUNTING BRACKETS¹

MFA104 (metal bracket strips)
MFA105 (aluminum brackets)

PACESETTER SERIES



MP162K

16" Reversible S-Blade



MP136K

13" Reversible S-Blade



MP119K

11" Reversible S-Blade

12V UNIVERSAL



MP089K

8" Reversible Straight Blade



MP109K

10" Reversible S-Blade



MP099K

9" Reversible Straight Blade

PACESETTER SERIES SPECIFICATIONS

PART #	FAN	BLADE	DIRECTION	MOTOR	DEPTH	CFM @ 0"	AMPS
MP162K	16" Medium Profile	S-Blade	Reversible	225W Heavy Duty	4.42"	1,746	12.9
MP166K	16" Medium Profile	S-Blade	Reversible	160W Heavy Duty	4.08"	1,661	15.6
MP136K	13" Medium Profile	S-Blade	Reversible	160W Heavy Duty	3.61"	1,356	9.4
MP119K	11" Low Profile	S-Blade	Reversible	90W Medium Duty	2.49"	727	7.7
MP109K	10" Low Profile	S-Blade	Reversible	90W Medium Duty	2.48"	666	4.5
MP099K	9" Low Profile	Straight Blade	Reversible	90W Medium Duty	2.55"	585	6.8
MP089K	8" Low Profile	Straight Blade	Reversible	90W Medium Duty	2.37"	391	5.1

¹ Fan accessories sold separately (except where noted). See pages 16 & 17 for accessory descriptions.

FAN ACCESSORIES

WIRE HARNESSES | CONNECTOR



MFA100

Harness w/Adjustable
Temperature Switch & Relay



MFA101

A/C Harness w/Relay



MFA102

Harness w/Temperature
Switch (MFA108) & Relay



MFA111

Dual Fan Adapter



MFA113

Fan Pigtail Connector



MFA103

Harness w/Temperature
Switch (MFA109) & Relay

TEMPERATURE CONTROL



MFA108

Temperature Switch for
Carburetor Engines



MFA109

Temperature Switch for
Fuel Injected Engines

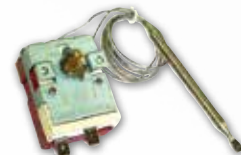

MFA110

Adjustable
Temperature Switch



MFA120

Adjustable Temperature
Switch w/TEW (non-relay)



MFA136

PWM Fan Controller
w/MFA137



MFA137

Variable Temperature Sensor

FAN ACCESSORIES

MOUNTING BRACKETS



M0912T

Replacement
Nylon Tie kit



MFA104

Metal Universal
Bracket Strips



MFA105

Billet Aluminum Universal
Mounting Brackets



MFA107

Jetstreme Series
Mounting Brackets



MFA112

Fan Rubber Spacer Kit

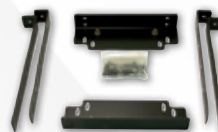

MFA125

Mach Two Extreme
Mounting Brackets



MFA138

Mach Two Mounting Brackets

FAN ACCESSORIES

PART #	NAME	DESCRIPTION
WIRE HARNESSES CONNECTOR (PAGE 16)		
MFA100	Harness w/Adjustable Temperature Switch & Relay	Heavy Gauge Wire Harness Relay Weatherproof Fuse Electrical Connectors Adjustable (32°F - 248°F) Temperature Switch
MFA101	A/C Harness w/Relay	Heavy Gauge Wire Harness Relay Weatherproof Fuse Electrical Connectors
MFA102	Harness w/Temperature Switch & Relay	Heavy Gauge Wire Harness Relay Weatherproof Fuse Electrical Connectors 185°F (Turns on at 185°F - Turns off at 170°F) Temperature switch
MFA103	Harness w/Temperature Switch & Relay	Heavy Gauge Wire Harness Relay Weatherproof Fuse Electrical Connectors 200°F (Turns on at 200°F - Turns off at 185°F) Temperature switch
MFA111	Dual Fan Adapter	Used with MFA 100, MFA 102, or MFA103 (Dual Fan Assemblies)
MFA113	Fan Pigtail Connector	For use with all <i>High Performance Fans</i> (Included with all Champion and Challenger Series fans).
TEMPERATURE CONTROL (PAGE 16)		
MFA108	Temperature Switch	For carbureted engines - 3/8" NPT (Turns on at 185°F - Turns off at 170°F) (replacement part for MFA102)
MFA109	Temperature Switch	For fuel injected engines - 3/8" NPT (Turns on at 200°F - Turns off at 185°F) (replacement part for MFA103)
MFA110	Adjustable Temperature Switch	Adjustable (32°F - 248°F) Temperature Switch (Fan Shut-Off at 20°F cooler than set point) (Includes mounting bracket and screws) (Replacement part for MFA100)
MFA120	Adjustable Temperature Switch w/TEW (non-relay)	8' Thermoplastic Equipment Wire Electrical Connectors Adjustable Temperature Switch
MFA136	PWM Fan Controller w/MFA137	Pulse-Width Modulation (PWM) Fan Controller Temperature Sensor MFA137
MFA137	Variable Temperature Sensor	For PWM Fan Controller - 1/8" NPT & Adapter for 1/2" NPT Water Jacket Inserts
TIE KITS MOUNTING BRACKETS (PAGE 17)		
M0912T	Replacement Nylon Tie kit	Included with all 130W Champion, Challenger and Pacesetter Series
MFA104	Metal Universal Bracket Strips (included with all fans)	(4) Brackets (4) Bolts (4) Washers (4) Nylon Lock Nuts (Brackets can be Bent and/or Trimmed for a Custom Fit)
MFA105	Billet Aluminum Universal Mounting Brackets	(2) Brackets (4) Bolts (4) Washers (4) Nylon Lock Nuts (Fits 14" and 16" <i>High Performance Fans</i>)
MFA107	Jetstreme Brackets (included with Jetstreme series)	Rotates 90° to Catch Top and Bottom or Side U-channels (Slotted Mounting Holes Adjust for Many Different Radiators)
MFA112	Fan Rubber Spacer Kit	For use with all Champion Series Fans (Included with all Champion Series fans)
MFA125	Universal Mach Two Extreme Mounting Brackets	All Years: All Makes • 34" Radiators
MFA138	1968-1971 Camaro/Firebird Mach Two Mounting Brackets	These Brackets are Specifically Designed for Aftermarket 24" Wide Radiators that have the Characteristic Hump on Top and Bottom of the Cross Flow Radiators which used a Rubber Insulated Clamp to Aid in Mounting them to the Core Support

HYDRONIC HEATERS

STOKER™ HEATER SERIES

UNIVERSAL
FLOOR | UNDER DASH MOUNT

9" STOKER™ HEATERS



MM-A1090002

9" Stoker™ w/2 – 3" Outlets



H-5670014²

4 Position Switch Kit



TA8000378²

Mounting Bracket for
Stoker Heaters

HYDRONIC HEATER

Uses Engine Coolant for Heat w/Tube & Fin Core

HEAVY DUTY NON-CORROSIVE CASE

Injection Molded Glass-Filled Nylon Case

ROBUST SINGLE SCROLL BLOWER

3" Wound Field Motor

AIRFLOW OPTIONS

Grille Face or 2 – 3" Outlets to Use Flex Duct

CONNECTIONS & MOUNTING

Side or Front Mount & Hose Connections at Rear

SUPERIOR QUALITY

Limited Warranty

INSTALLATIONS KITS¹

H-64006 (heater plumbing kit)

MFA129 (engine fitting kit)

LOUVER / DEFROST KITS¹

MFA128 (3" defrost kit)

MFA130 (3" louver kit)

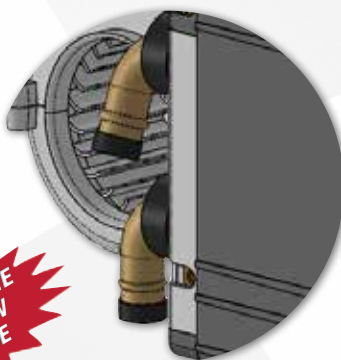

**90° WATER LINE
OPTION NOW
AVAILABLE**

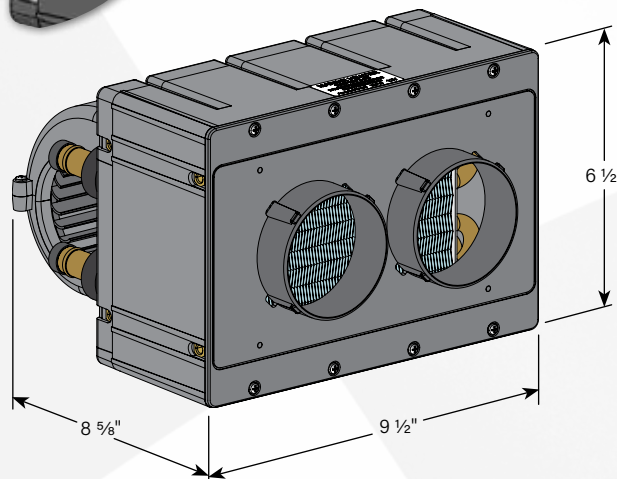

9 1/2" W x 6 1/2" H x 8 5/8" D

HYDRONIC HEATERS

AVAILABLE OUTLET OPTIONS

2 – 3" OUTLETS | FLANGED GRILLE | GRILLE



MM-A1090004

9" Stoker™ w/Flanged Grille

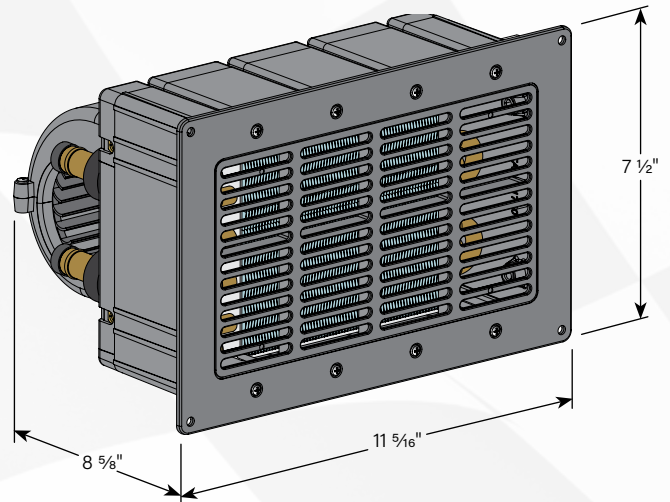

11 ⁵/₁₆" W x 7 ¹/₂" H x 8 ⁵/₈" D



MM-A1090009

9" Stoker™ w/Grille

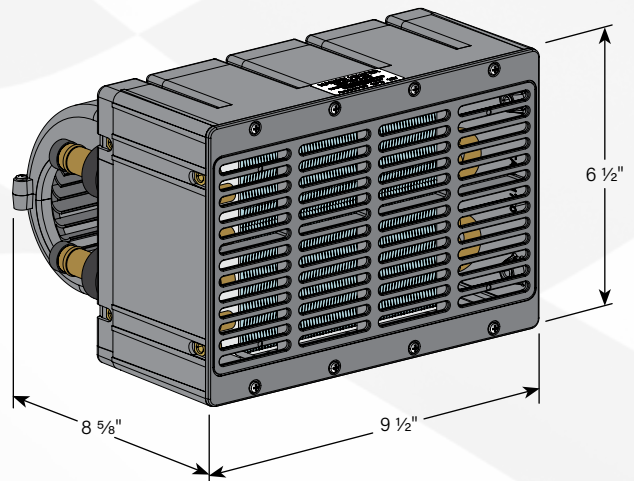

9 ¹/₂" W x 6 ¹/₂" H x 8 ⁵/₈" D

STOKER™ SERIES SPECIFICATIONS

PART #	CASE/BLOWER MATERIAL	CORE MATERIAL	POWER REQUIREMENTS	MOTOR	BTUS/HR	AIRFLOW	HOSE BARB
MM-A1090002	Glass-Filled Nylon	Tube & Fin	9.6 Amps @ 12V	3-Speed	26,000	200 CFM	5/8"
MM-A1090004 ²	Glass-Filled Nylon	Tube & Fin	9.6 Amps @ 12V	3-Speed	26,000	200 CFM	5/8"
MM-A1090009	Glass-Filled Nylon	Tube & Fin	9.6 Amps @ 12V	3-Speed	26,000	200 CFM	5/8"

¹ Heater accessories sold separately (except where noted). See pages 28 & 29 for accessory descriptions.

² Switch Kit H-5670014 & Mounting Brackets TA8000378 are included with all Stoker models (mounting brackets not included with MM-1090004).

HYDRONIC HEATERS

STOKER™ HEATER SERIES

UNIVERSAL
FLOOR | UNDER DASH MOUNT

16" STOKER™ HEATER



MM-A1160005

16" Stoker™ w/3 – 3" Outlets



H-5670014²

4 Position Switch Kit



TA8000378²

Mounting Bracket for
Stoker Heaters

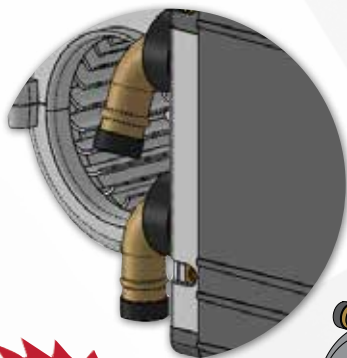

**90° WATER LINE
OPTION NOW
AVAILABLE**

HYDRONIC HEATER

Uses Engine Coolant for Heat w/Tube & Fin Core

HEAVY DUTY NON-CORROSIVE CASE

Injection Molded Glass-Filled Nylon Case

ROBUST DUAL SCROLL BLOWER

3" Wound Field Motor

AIRFLOW OPTIONS

3 – 3" Outlets to Use Flex Duct

CONNECTIONS & MOUNTING

Side or Front Mount & Hose Connections at Rear

SUPERIOR QUALITY

Limited Warranty

INSTALLATIONS KITS¹

H-64006 (heater plumbing kit)

MFA129 (engine fitting kit)

LOUVER / DEFROST KITS¹

MFA128 (defrost kit)

MFA130 (louver kit)

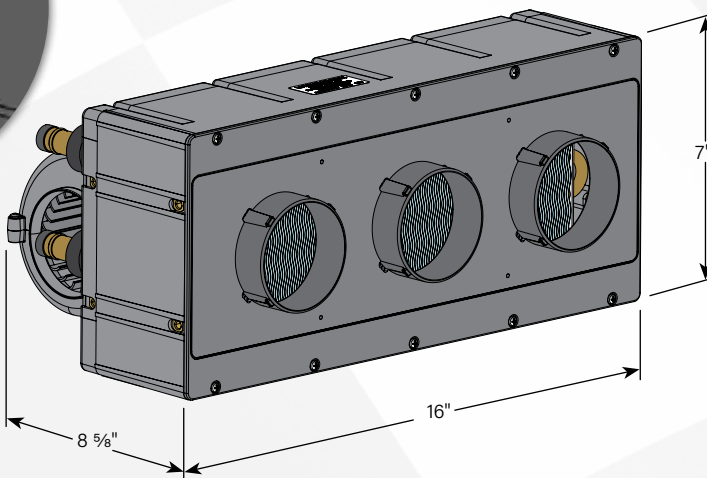

16" W x 7" H x 8 5/8" D

STOKER™ SERIES SPECIFICATIONS

PART #	CASE/BLOWER MATERIAL	CORE MATERIAL	POWER REQUIREMENTS	MOTOR	BTUS/HR	AIRFLOW	HOSE BARB
MM-A1160005	Glass-Filled Nylon	Tube & Fin	11.6 Amps @ 12V	3-Speed	40,000	300 CFM	5/8"

¹ Heater accessories sold separately (except where noted). See pages 28 & 29 for accessory descriptions.

² Switch Kit H-5670014 & Mounting Brackets TA8000378 are included with all Stoker models.

HYDRONIC HEATERS

HYDRONIC HEATER

Uses Engine Coolant for Heat w/Tube & Fin Core

RIGID CASE

22 Ga. Steel Case with Black Finish

7" ALUMINUM FAN BLADE

3" Wound Field Motor

AIRFLOW OPTIONS

Vents with Doors and 2 – 2" Outlets to Use Flex Duct
(Top Rotates to Desired Position)

CONNECTIONS & MOUNTING

Bottom Mounting & Hose Connections at Rear

SUPERIOR QUALITY

Limited Warranty

INSTALLATION KITS¹

H-64006 (heater plumbing kit)
MFA129 (engine fitting kit)
H-5670004 (switch w/harness)
H-5670005 (switch w/harness)

LOUVER / DEFROST KITS¹

MFA126 (defrost kit)
MFA127 (louver kit)

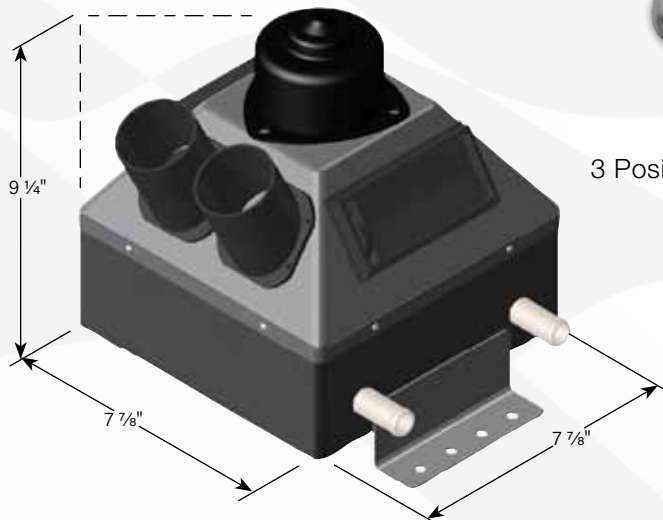

MOUNTING WIDTH INCLUDING BUILT-IN BRACKET IS 10 1/4"

7 7/8" W x 9 1/4" H x 7 7/8" D

CARLSBAD HEATER

UNIVERSAL WALL | FLOOR MOUNT



HT-100012

Wall/Under Dash Mount Heater



MFA133²

3 Position Heater Switch



CARLSBAD HEATER SPECIFICATIONS

PART #	CASE/BLOWER MATERIAL	CORE MATERIAL	POWER REQUIREMENTS	MOTOR	BTUS/HR	AIRFLOW	HOSE BARB
HT-100012	Heat Resistant ABS	Tube & Fin	9.0 Amps @ 12V	2-Speed	22,000	80 CFM	5/8"

¹ Heater accessories sold separately (except where noted). See pages 28 & 29 for accessory descriptions.

² Switch MFA133 is included.

HYDRONIC HEATERS

DURANGO

HEATER

UNIVERSAL
WALL | UNDER DASH MOUNT



HF-100012
Wall/Under Dash Mount Heater

HYDRONIC HEATER

Uses Engine Coolant for Heat w/Tube & Fin Core

COMPACT DESIGN

Excellent for Small Cabins

AIRFLOW LOUVERS

2 - 2.5" Adjustable Louvers

CONNECTIONS & MOUNTING

Mounting Bracket Included for Under Dash & Hose Connections at Rear

SUPERIOR QUALITY

Limited Warranty



MFA133²
3 Position Heater Switch



TA8001646²
Mounting Bracket for Durango Heater



7 3/4" W x 4 5/8" H x 9 1/2" D

DURANGO HEATER SPECIFICATIONS

PART #	CASE/BLOWER MATERIAL	CORE MATERIAL	POWER REQUIREMENTS	MOTOR	BTUS/HR	AIRFLOW	HOSE BARB
HF-100012	Heat Resistant ABS	Tube & Fin	1.9 Amps @ 12V	2-Speed	8,500	80 CFM	5/8"

¹ Heater accessories sold separately (except where noted). See pages 28 & 29 for accessory descriptions.

² Switch MFA133 & Mounting Bracket TA8001646 are included.

HYDRONIC HEATERS

HYDRONIC HEATER

Uses Engine Coolant for Heat w/Tube & Fin Core

COMPACT DESIGN

Excellent for Small Cabins

AIRFLOW LOUVERS

3 – 2.5" Adjustable Louvers

CONNECTIONS & MOUNTING

Mounting Bracket Included for Under Dash & Hose Connections at Rear

SUPERIOR QUALITY

Limited Warranty

INSTALLATIONS KITS¹

H-64006 (heater plumbing kit)

MFA129 (engine fitting kit)

HAVASU HEATER

UNIVERSAL WALL | UNDER DASH MOUNT



HF-200012

Wall/Under Dash Mount Heater



MFA133²

3 Position Heater Switch



TA8001647²

Mounting Bracket for Havasu Heater



10 ¼" W x 4 ½" H x 7 ⅞" D

HAVASU HEATER SPECIFICATIONS

PART #	CASE/BLOWER MATERIAL	CORE MATERIAL	POWER REQUIREMENTS	MOTOR	BTUS/HR	AIRFLOW	HOSE BARB
HF-200012	Heat Resistant ABS	Tube & Fin	6.8 Amps @ 12V	2-Speed	20,000	177 CFM	5/8"

¹ Heater accessories sold separately (except where noted). See pages 28 & 29 for accessory descriptions.

² Switch MFA133 & Mounting Bracket TA8001647 are included.

HYDRONIC HEATERS

SEDONA HEATER

**UNIVERSAL
WALL | FLOOR MOUNT**



HF-300012

Wall/Floor Mount Heater

HYDRONIC HEATER

Uses Engine Coolant for Heat w/Tube & Fin Core

HEAVY DUTY NON-CORROSIVE CASE

Injection Molded ABS Case

AIRFLOW LOUVERS

4 – 2" Adjustable Louvers

CONNECTIONS & MOUNTING

Mounting Brackets on Frame & Hose Connections on Bottom

TEMPERATURE CONTROL

Built-in Water Control Valve and 3-Speed Switch

SUPERIOR QUALITY

Limited Warranty

INSTALLATIONS KITS¹

H-64006 (heater plumbing kit)

MFA129 (engine plumbing kit)



MOUNTING WIDTH INCLUDING BUILT-IN BRACKET IS 8 5/8"
MOUNTING HEIGHT INCLUDING BUILT-IN BRACKET IS 13 1/5"

7 31/32" W x 12 5/8" H x 6 11/16" D

SEDONA HEATER SPECIFICATIONS

PART #	CASE/BLOWER MATERIAL	CORE MATERIAL	POWER REQUIREMENTS	MOTOR	BTUS/HR	AIRFLOW	HOSE BARB
HF-300012	Heat Resistant ABS	Tube & Fin	8.0 Amps @ 12V	3-Speed	17,750	80 CFM	5/8"

¹ Heater accessories sold separately (except where noted). See pages 28 & 29 for accessory descriptions.

HYDRONIC HEATERS

HYDRONIC HEATER

Uses Engine Coolant for Heat w/Tube & Fin Core

HEAVY DUTY NON-CORROSIVE CASE

Injection Molded ABS Case

AIRFLOW LOUVERS

4 – 2" Adjustable Louvers

CONNECTIONS & MOUNTING

Mounting Brackets Included for Wall Mount &
Hose Connections on Bottom

TEMPERATURE CONTROL

Built-in Water Control Valve and 3-Speed Switch

SUPERIOR QUALITY

Limited Warranty

INSTALLATIONS KITS¹

H-64006 (heater plumbing kit)

MFA129 (engine fitting kit)



SONORA HEATER

UNIVERSAL WALL | FLOOR MOUNT



HF-310012

Wall/Floor Mount Heater



8 11/32" W x 12 5/16" H x 5 15/16" D

HAVASU HEATER SPECIFICATIONS

PART #	CASE/BLOWER MATERIAL	CORE MATERIAL	POWER REQUIREMENTS	MOTOR	BTUS/HR	AIRFLOW	HOSE BARB
HF-310012	Heat Resistant ABS	Tube & Fin	6.8 Amps @ 12V	3-Speed	12,000	80 CFM	5/8"

¹ Heater accessories sold separately (except where noted). See pages 28 & 29 for accessory descriptions.

HYDRONIC HEATERS

SANTA FE HEATER

**UNIVERSAL
WALL | FLOOR MOUNT**



H-400012

Wall/Floor Mount Heater

HYDRONIC HEATER

Uses Engine Coolant for Heat w/Tube & Fin Core

HEAVY DUTY NON-CORROSIVE CASE

Injection Molded Glass-Filled Nylon Case

6" ALUMINUM FAN BLADE

3" Wound Field Motor

AIRFLOW LOUVERS

4 – 4" Adjustable Louvers

CONNECTIONS & MOUNTING

Mounting Studs & Hose Connections at Bottom

SUPERIOR QUALITY

Limited Warranty

INSTALLATIONS KITS¹

H-64006 (heater plumbing kit)

MFA129 (engine fitting kit)

LOUVER / DEFROST KITS¹

MFA126 (defrost kit)

MFA127 (louver kit)

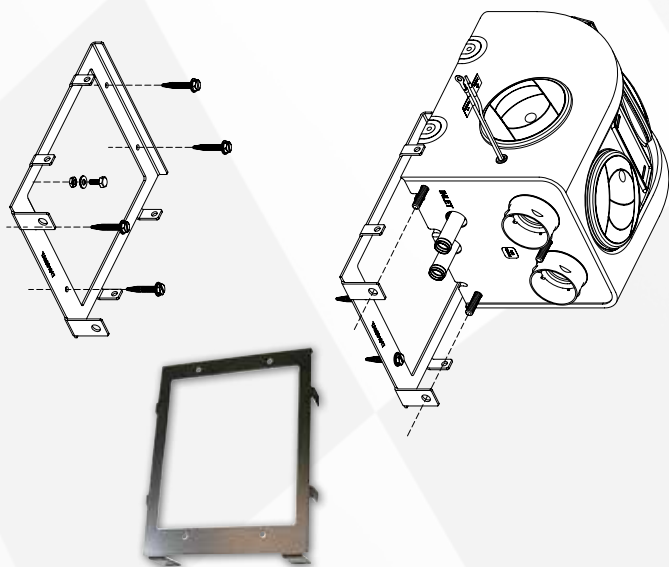

MFA132¹

Mounting Bracket for
Santa Fe Heater

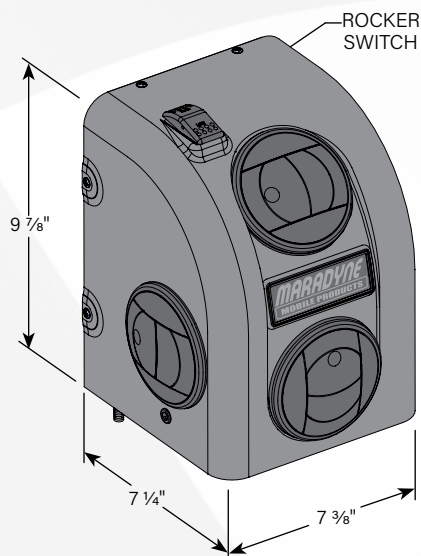

7 3/8" W x 9 7/8" H x 7 1/4" D

SANTA FE HEATER SPECIFICATIONS

PART #	CASE MATERIAL	FAN MATERIAL	CORE MATERIAL	POWER REQUIREMENTS	MOTOR	BTUS/HR	AIRFLOW	HOSE BARB
H-400012	Glass-Filled Nylon	Aluminum	Tube & Fin	3.1 Amps @ 12V	3-Speed	13,200	200 CFM	5/8"

¹ Heater accessories sold separately (except where noted). See pages 28 & 29 for accessory descriptions.

HYDRONIC HEATERS

HYDRONIC HEATER

Uses Engine Coolant for Heat w/Tube & Fin Core

RIGID CASE

22 Ga. Steel Case with Black Finish

HEAVY DUTY MOTOR

3" Non-Vented Wound Field (Internally Grounded)

AIRFLOW OPTIONS

Vents with Doors or 2" Outlets to Use Flex Duct

CONNECTIONS & MOUNTING

Mounting Studs & Hose Connections at Rear

SUPERIOR QUALITY

Limited Warranty

INSTALLATIONS KITS¹

H-64006 (heater plumbing kit)
MFA129 (engine fitting kit)
H-5670004 (switch w/harness)
H-5670005 (switch w/harness)

LOUVER / DEFROST KITS¹

MFA126 (defrost kit)
MFA127 (louver kit)

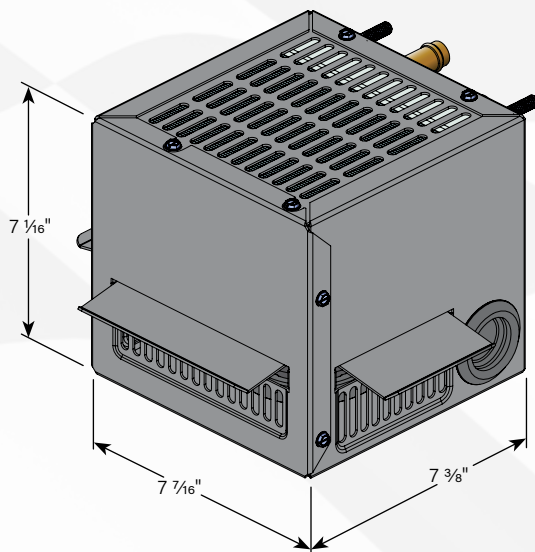

7 1/16" W x 7 1/16" H x 7 3/8" D

THE HEAT 5000 HEATER

UNIVERSAL WALL | FLOOR MOUNT



H-503012

Wall/Floor Mount Heater



H-5670014²

4 Position Switch Kit



THE HEAT 5000 HEATER SPECIFICATIONS

PART #	CASE MATERIAL	FAN MATERIAL	CORE MATERIAL	POWER REQUIREMENTS	MOTOR	BTUS/HR	AIRFLOW	HOSE BARB
H-503012	18 Gauge Steel	Aluminum	Tube & Fin	3.0 Amps @ 12V	3-Speed	13,200	200 CFM	5/8"

¹ Heater accessories sold separately (except where noted). See pages 28 & 29 for accessory descriptions.
² Switch Kit H-5670014 included.

HEATER ACCESSORIES

SWITCH KITS



H-5670014

4 Position Switch Kit



TA7000078

4 Position Switch Kit

WIRE HARNESSES



H-5670004

H-5670014 & Wire Harness



H-5670005

TA7000078 & Wire Harness

SWITCHES



MFA133

3 Position Heater Switch



MFA134

4 Position Heater Switch



MFA135

Inline Water Control Valve

DEFROST KITS



MFA126

2" Defrost Kit



MFA128

3" Defrost Kit

LOUVER KITS



MFA127

2" Louver Kit



MFA130

3" Louver Kit

HEATER ACCESSORIES

ASSEMBLY KITS



H-64006

Heater Plumbing Kit



MFA129

Engine Fitting Kit

MOUNTING BRACKETS



MFA132

Mounting Bracket for
Santa Fe Heater



TA8000378

Mounting Bracket for
Stoker Heaters



TA8001646

Mounting Bracket for
Durango Heater



TA8001647

Mounting Bracket for
Havasu Heater

HEATER ACCESSORIES

PART #	NAME	DESCRIPTION
WIRE HARNESSES (PAGE 18)		
H-5670014	Switch Kit	Switch w/3-Speed Switch Plate
TA7000078	Switch Kit	Switch w/3-Speed Switch Plate
SWITCH KITS (PAGE 18)		
H-5670004	H-5670014 & Wire Harness	Switch Kit (H-5670014) w/3' Wire Harness
H-5670005	TA7000078 & Wire Harness	Switch Kit (TA7000078) w/3' Wire Harness
SWITCHES (PAGE 18)		
MFA133	3 Position Heater Switch (Durango & Havasu Heaters)	Modern Style 3 Position Switch for 2-Speed (Hi-Lo) (Works with any 2-Speed Heater) (Switch, Knob & Bezel Only - Designed for Dash or Wall Mount)
MFA134	4 Position Heater Switch (Stoker & Heat 5000 Heaters)	Modern Style 4 Position switch 3-speed (Hi-Med-Low) (works with any 3-speed heater) (Switch, Knob & Bezel Only)
MFA135	Inline Water Control Valve	Modern Style Water Valve to Control Hot Coolant Flow
DEFROST KITS (PAGE 18)		
MFA126	Defrost Kit	For Santa Fe & The Heat 5000 Heaters w/2" Outlets
MFA127	Louver Kit	For Santa Fe & The Heat 5000 Heaters w/2" Outlets
LOUVER KITS (PAGE 18)		
MFA128	Defrost Kit	For Stoker Series Heaters w/3" Outlets
MFA130	Louver Kit	For Stoker Series Heaters w/3" Outlets
ASSEMBLY KITS (PAGE 18)		
H-64006	Heater Plumbing Kit	(12.5') 5/8" Heater Hose Water Shutoff Valve 1/2" x 3/8" Bushing 5/8" Hose Connector 4 Hose Clamps
MFA129	Engine Fitting Kit	(10') 5/8" Heater Hose 2 1/2" MPT x 5/8" Hose Barb (4) 1 1/8" Mounting Clamp 4 Hose Clamps
MOUNTING BRACKETS (PAGE 19)		
MFA132	Mounting Bracket	For Santa Fe Heater
TA8000378	Mounting Bracket	For Stoker Series Heaters
TA8001646	Mounting Bracket	For Durango Heater
TA8001647	Mounting Bracket	For Havasu Heater

SPECIALTY ITEMS

TEXAS TWISTER NYLON FAN BLADES



- Engine driven flex fan
- All glass-filled nylon construction
- Lightweight (lowers drag & improves engine performance over metal fan blades)
- Includes mounting washers
- Up to 8,000 rpm max

TEXAS TWISTER SPECIFICATIONS

PART #	STYLE	SIZE
MFA118	Fan Blade Kit w/Washers	18"
MFA117	Fan Blade Kit w/Washers	17"
MFA116	Fan Blade Kit w/Washers	16"
MFA115	Fan Blade Kit w/Washers	15"
MFA114	Fan Blade Kit w/Washers	14"



MFA118

18" Fan Blade Kit w/Washers

junior jet 150

- Designed for vehicle tires used on trucks, SUV's, vans, cars, bikes and inflatables
- Heavy duty, gearless, direct drive motor
- Cigarette lighter adaptor w/9 ft. power cord
- 27 in. high pressure coiled air hose (expands to 12 ft.) with quick release connector
- Built-in air pressure gauge (0 – 150psi)
- Oil-less design, maintenance free
- 75db low noise, air flow 35L/min.
- Working pressure: 150psi/10bar
- Average fill rate on 16" tire 7lbs/min.



MJJ150

Portable Air Pump

junior jet 150

INCLUDES

- Plastic Inflatable Nozzles (2)
- Quick Release Coiled Air Hose
- Ball Needle
- Replacement Fuse
- Nylon Carry Case



- Drawn Steel Base
- Round Three-Hole Mount
- Adjustable Position Swivel
- Two-Speed Medium Duty Motor
- Mounting Hardware & Gasket (included)
- Externally Grounded

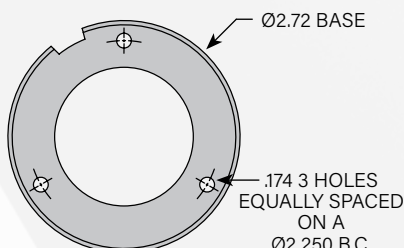

CFM High: 210
CFM Low: 140

Amps High: 1.1
Amps Low: 0.5

MDF-100012

Dash Fan

INDEX

PART #	DESCRIPTION	PAGE	PART #	DESCRIPTION	PAGE
H-400012	Santa Fe Hydronic Heater	23	MFA125	Universal Mach Two Extreme Mounting Brackets	17
H-503012	The Heat 5000 Hydronic Heater	27	MFA126	Defrost Kit for Heaters w/2" Outlets	21, 28 & 29
H-5670004	Switch Kit w/Wire Harness and Tie Wraps	21 & 27-29	MFA127	Louver Kit for Heaters w/2" Outlets	21, 28 & 29
H-5670005	Switch Kit w/Wire Harness and Tie Wraps	21 & 27-29	MFA128	Defrost Kit for Heaters w/3" Outlets	18, 20, 28 & 29
H-5670014	Switch Kit	18, 20 & 27-29	MFA129	Engine Fitting Kit for Stoker Heaters	20, 24 & 29
H-64006	Heater Hose Kit	21-29	MFA130	Defrost Kit for Heaters w/3" Outlets	18, 20, 28 & 29
HF-100012	Durango Hydronic Single Scroll Heater	22	MFA132	Mounting bracket for Santa Fe Heater	26 & 29
HF-200012	Havasu Hydronic Dual Scroll Heater	23	MFA133	3-Position Heater Switch	21-23, 28 & 29
HF-300012	Sedona Hydronic Heater	24	MFA134	4-Position Heater Switch	28 & 29
HF-310012	Sonora Hydronic Heater	25	MFA135	Inline Water Control Valve	28 & 29
HT-100012	Carlsbad Hydronic Heater	21	MFA136	PWM Fan Controller w/Temperature Sensor	16 & 17
M059K	Champion 5" 90w puller only	10 & 11	MFA137	Variable Temperature Sensor	16 & 17
M073K	Champion 7" Reversible 130w	11	MFA138	Mach Two Mounting Brackets	12 & 17
M083K	Champion 8" Reversible 130w	10 & 11	MJ150	Junior Jet 150 PSI w/Carry Bag and Accessories	30
M0912T	Nylon Pull Through Mounting Tie Kit	17	MJS12KPS	Jetstreme I Platinum Supreme - 12" Shrouded Puller 225w	7
M093K	Champion 9" Reversible 130w	11	MJS12KPSC	MJS12KPS w/MFA100	7
M103K	Champion 10" Reversible 130w	10 & 11	MJS13K	Jetstreme I - 12" Shrouded Puller 130w	8 & 9
M113K	Champion 11" Reversible 130w	11	MJS13KC	MJS13K w/MFA100	9
M122K	Champion 12" Reversible 225w	10 & 11	MJS16K	Jetstreme I - 12" Shrouded Puller 160w	8 & 9
M123K	Champion 12" Reversible 130w	11	MJS16KC	MJS16K w/MFA100	9
M142K	Champion 14" Reversible 225w	10 & 11	MJS22K	Jetstreme II - Dual 12" Shrouded Puller 225w	9
M143K	Champion 14" Ultra Thin Puller 130w	11	MJS22KC	MJS22K w/MFA100	9
M146K	Champion 14" Reversible 160w	11	MJS22KPS	Jetstreme II Platinum Supreme - Dual 12" Shrouded Puller 225w	7
M162K	Champion 16" Reversible 225w	10 & 11	MJS22KPSC	MJS22KPS w/MFA100	7
M163K	Champion 16" Ultra Thin Puller 130w	11	MJS23K	Jetstreme II - Dual 12" Shrouded Puller 130w	9
M166K	Champion 16" Reversible 160w	11	MJS23KC	MJS23K w/MFA100	9
MC109K	Challenger 10" Reversible 90w	14	MJS26K	Jetstreme II - Dual 12" Shrouded Puller 160w	9
MC119K	Challenger 11" Reversible 90w	14	MJS26KC	MJS26K w/MFA100	9
MC136K	Challenger 13" Reversible 160w	14	MM-A1090002	9" Stoker w/2 - 3" Outlets	18 & 19
MC162K	Challenger 16" Reversible 225w	14	MM-A1090004	9" Stoker w/Flanged Grille	19
MC166K	Challenger 16" Reversible 160w	14	MM-A1090009	9" Stoker w/Grille	19
MDF-200012	Cool Cat Dash Fan	30	MM-A1160005	16" Stoker w/3 - 3" Outlets	20
MFA100	Relay Harness w/Adjustable Thermostat	8, 10, 12 & 14-17	MM12K	Mach One - 16" Shrouded Puller 225w	12 & 13
MFA101	A/C Fan Harness w/Relay	8, 10, 12 & 14-17	MM12KC	MM12K w/MFA100	13
MFA102	Relay Harness w/MFA108	8, 10, 12 & 14-17	MM22K	Mach Two - Dual 11" Shrouded Puller 225w	13
MFA103	Relay Harness w/MFA109	8, 10, 12 & 14-17	MM22KS	MM22K w/Side Flanges	13
MFA104	Metal Universal Mounting Bracket Strips	10, 14, 15 & 17	MM22KT	MM22K Top & Bottom Flanges	13
MFA105	Aluminum Universal Mounting Brackets	10, 14, 15 & 17	MM22KX	Mach Two - Dual 16" Shrouded Puller 225w	12 & 13
MFA107	Jetstreme I & II Universal Mounting Brackets	12 & 17	MP089K	Pacesetter 8" Reversible 90w	15
MFA108	185° Temperature Switch	16 & 17	MP099K	Pacesetter 9" Reversible 90w	15
MFA109	195° Temperature Switch	16 & 17	MP109K	Pacesetter Reversible 10" 90w	15
MFA110	Adjustable Temperature Switch	16 & 17	MP119K	Pacesetter 11" Reversible 90w	15
MFA111	Dual Fan Adapter Harness	7, 8, 12, 16 & 17	MP136K	Pacesetter 13" Reversible 160w	15
MFA112	Rubber Spacer Mounting Kit	17	MP162K	Pacesetter 16" Reversible 225w	15
MFA113	Pigtail Connector (for all Maradyne Fans)	10, 16 & 17	MP166K	Pacesetter 16" Reversible 160w	15
MFA114	14" Texas Twister Fan Blade	30	TA7000078	Switch Kit	28 & 29
MFA115	15" Texas Twister Fan Blade	30	TA8000378	Mounting Bracket for Stoker Heaters	18, 20 & 29
MFA116	16" Texas Twister Fan Blade	30	TA8001646	Mounting Bracket for Durango Heater	22 & 29
MFA117	17" Texas Twister Fan Blade	30	TA8001647	Mounting Bracket for Havasu Heater	23 & 29
MFA118	18" Texas Twister Fan Blade	30	TA11A3001	Champion 11" High Profile Puller 225w	11
MFA120	Adj. Thermostat w/Wire Harness (no relay)	16 & 17	TA12A3001	Champion 12" High Profile Puller 225w	11

MARADYNE®

HIGH PERFORMANCE FANS

Manufacturing quality fans for over 20 years!

PRODUCT CATALOG

Volume 15



Designed by Our Engineers • Built in Our Facilities

Other DCM • FAZ Products:



4540 W. 160th St. • Cleveland, OH 44135 • Fax: (216) 362-6342

MaradyneHP.com • (800) 403-7953