

# ***GPF SYSTEMS***



**Great Plains Fastening Systems, Inc.**

**P.O. Box 793  
Concordia, MO. 64020**

**Phone and Fax: 1.800.886.4249  
Email: [greatplainsinc@centurytel.net](mailto:greatplainsinc@centurytel.net)**

**Visit us at: <http://gpfsystems.com/>**

**ALUMINUM BODY  
ALUMINIUM MANDREL**

**ISO 9001 Certified  
Made according to IFI Specifications**

Material  
Body 5052 (AlMg2.5)  
Mandrel 7000 Series

Aluminum Alloy

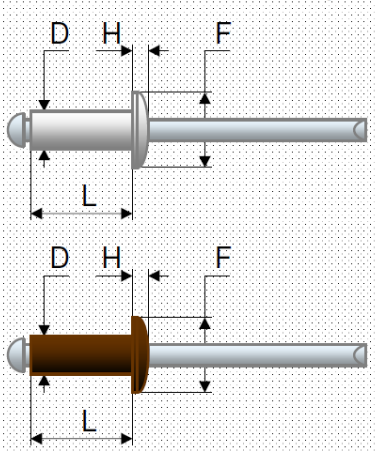

Finishes

Body Polished  
Colour Painted  
Mandrel Polished

Recommended Drill/Hole Size		
1/8"	dia. rivet	#30
5/32"	dia. rivet	#20
3/16"	dia. rivet	#11
1/4"	dia. rivet	F

Rivet Code	D mm inch nom	Hole Dia mm inch		L inch	Grip Range inch		F mm inch nom	H mm inch max	Typical Ultimate Strength	
		min	max		min.	max.			Shear N lbs	Tensile N lbs
A32A	2.4	2.5	2.6	0.252	0.063	0.126	4.75	0.80	310	360
A34A	3/32	.097	.101	0.374	0.126	0.250	.188	.032	70	80
A36A				0.500	0.250	0.375				
A41A				0.213	0.031	0.063				
A42A				0.276	0.063	0.126				
A43A				0.339	0.126	0.189				
A44A	3.2	3.3	3.4	0.402	0.189	0.252	6.35	1.05	530	670
A45A	1/8	.129	.133	0.465	0.252	0.312	.250	.041	120	150
A46A				0.524	0.312	0.375				
A48A				0.650	0.375	0.500				
A410A				0.776	0.500	0.625				
A52A				0.299	0.063	0.126				
A53A				0.362	0.126	0.187				
A54A	4.0	4.1	4.2	0.425	0.188	0.250	7.95	1.30	850	1020
A56A	5/32	.160	.164	0.551	0.250	0.375	.312	.051	190	230
A58A				0.673	0.375	0.500				
A510A				0.799	0.500	0.625				
A62A				0.327	0.063	0.126				
A63A				0.390	0.126	0.187				
A64A				0.449	0.188	0.250				
A66A				0.575	0.250	0.375				
A68A	4.8	4.9	5.0	0.701	0.375	0.500	9.50	1.55	1160	1430
A610A	3/16	.192	.196	0.827	0.500	0.625	.375	.061	260	320
A612A				0.949	0.625	0.750				
A614A				1.075	0.750	0.875				
A616A				1.201	0.875	1.000				
A618A				1.327	1.000	1.125				
A82A				0.374	0.063	0.126				
A84A				0.500	0.188	0.250				
A86A				0.626	0.250	0.375				
A88A	6.4	6.5	6.6	0.748	0.375	0.500	12.70	2.05	2050	2500
A810A	1/4	.257	.261	0.874	0.500	0.625	.500	.081	460	560
A812A				1.000	0.625	0.750				
A814A				1.122	0.750	0.875				
A816A				1.248	0.875	1.000				

**ALUMINUM BODY  
ALUMINIUM MANDREL**

**ISO 9001 Certified  
Made according to IFI Specifications**

Material  
Body 5052 (AlMg2.5)  
Mandrel 7000 Series  
Aluminum Alloy

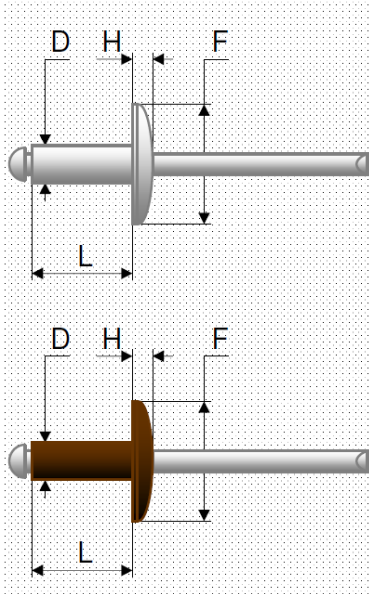

Finishes  
Body Polished  
Colour Painted  
Mandrel Polished

**Recommended Drill/Hole  
Size**

1/8" dia. rivet #30  
5/32" dia. rivet #20  
3/16" dia. rivet #11  
1/4" dia. rivet F

Rivet Code	D mm inch nom	Hole Dia mm inch		L inch	Grip Range inch		F mm inch nom	H mm inch max	Typical Ultimate Strength	
		min	max		min.	max.			Shear N lbs	Tensile N lbs
AL42A				0.276	0.063	0.126				
AL43A				0.339	0.126	0.189				
AL44A				0.402	0.189	0.252				
AL45A	3.2 1/8	3.3 .129	3.4 .133	0.465	0.252	0.312	9.50 .375	1.65 .065	530 120	670 150
AL46A				0.524	0.312	0.375				
AL48A				0.650	0.375	0.500				
AL410A				0.776	0.500	0.625				
AL52A				0.299	0.063	0.126				
AL53A				0.362	0.126	0.187				
AL54A	4.0	4.1	4.2	0.425	0.188	0.250	11.90	1.90	850	1020
AL56A	5/32	.160	.164	0.551	0.250	0.375	.468	.075	190	230
AL58A				0.673	0.375	0.500				
AL510A				0.799	0.500	0.625				
AL62A				0.327	0.063	0.126				
AL63A				0.390	0.126	0.187				
AL64A				0.449	0.188	0.250				
AL66A				0.575	0.250	0.375				
AL68A	4.8	4.9	5.0	0.701	0.375	0.500	13.90	2.15	1160	1430
AL610A	3/16	.192	.196	0.827	0.500	0.625	.547	.085	260	320
AL612A				0.949	0.625	0.750				
AL614A				1.075	0.750	0.875				
AL616A				1.201	0.875	1.000				
AL618A				1.327	1.000	1.125				

**ALUMINUM BODY  
ALUMINIUM MANDREL**

**ISO 9001 Certified  
Made according to IFI Specifications**

Material  
Body 5052 (AlMg2.5)  
Mandrel 7000 Series

Aluminum Alloy

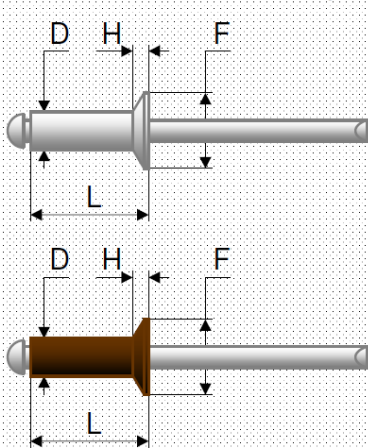

Finishes  
Body Polished  
Colour Painted  
Mandrel Polished

Recommended Drill/Hole Size		
1/8" dia. rivet	#30	
5/32" dia. rivet	#20	
3/16" dia. rivet	#11	
1/4" dia. rivet	F	

Rivet Code	D mm inch nom	Hole Dia mm inch		L inch	Grip Range inch		F mm inch nom	H mm inch max	Typical Ultimate Strength	
		min	max		min.	max.			Shear N lbs	Tensile N lbs
AC32A	2.4	2.5	2.6	0.252	0.063	0.126	4.75	0.80	400	535
AC34A	3/32	.097	.101	0.374	0.126	0.250	.188	.032	90	120
AC36A				0.500	0.250	0.375				
AC42A				0.276	0.063	0.126				
AC43A				0.339	0.126	0.189				
AC44A	3.2	3.3	3.4	0.402	0.189	0.252	5.60	1.05	530	670
AC45A	1/8	.129	.133	0.465	0.252	0.312	.220	.041	120	150
AC46A				0.524	0.312	0.375				
AC48A				0.650	0.375	0.500				
AC52A				0.299	0.063	0.126				
AC53A				0.362	0.126	0.187				
AC54A	4.0	4.1	4.2	0.425	0.188	0.250	7.15	1.30	850	1020
AC56A	5/32	.160	.164	0.551	0.250	0.375	.281	.051	190	230
AC58A				0.673	0.375	0.500				
AC510A				0.799	0.500	0.625				
AC62A				0.327	0.063	0.126				
AC63A				0.390	0.126	0.187				
AC64A	4.8	4.9	5.0	0.449	0.188	0.250	8.85	1.55	1160	1430
AC66A	3/16	.192	.196	0.575	0.250	0.375	.348	.061	260	320
AC68A				0.701	0.375	0.500				
AC610A				0.827	0.500	0.625				
AC84A				0.500	0.188	0.250				
AC86A				0.626	0.250	0.375				
AC88A	6.4	6.5	6.6	0.748	0.375	0.500	12.00	2.05	2050	2500
AC810A	1/4	.257	.261	0.874	0.500	0.625	.472	.081	460	560
AC812A				1.000	0.625	0.750				



**ALUMINUM BODY  
STEEL MANDREL**

**ISO 9001 Certified  
Made according to IFI Specifications**

Material  
Body 5056 (AlMg5)  
Mandrel Carbon Steel

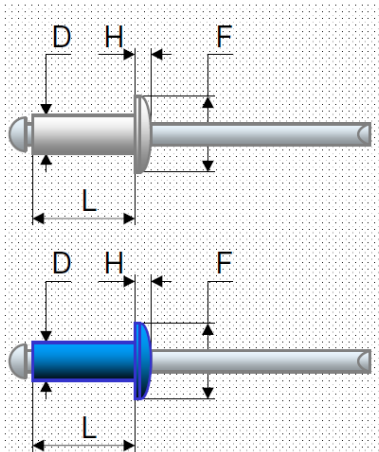

Finishes  
Body Polished  
Mandrel Colour Painted  
Zinc Plating

Recommended Drill/Hole Size	
1/8" dia. rivet	#30
5/32" dia. rivet	#20
3/16" dia. rivet	#11
1/4" dia. rivet	F

Rivet Code	D mm inch nom	Hole Dia mm inch		L inch	Grip Range inch		F mm inch nom	H mm inch max	Typical Ultimate Strength	
		min	max		min.	max.			Shear N lbs	Tensile N lbs
A32S	2.4	2.5	2.6	0.252	0.063	0.126	4.75	0.80	400	535
A34S	3/32	.097	.101	0.374	0.126	0.250	.188	.032	90	120
A36S				0.500	0.250	0.375				
A41S				0.213	0.031	0.063				
A42S				0.276	0.063	0.126				
A43S				0.339	0.126	0.189				
A44S	3.2	3.3	3.4	0.402	0.189	0.252	6.35	1.05	760	980
A45S	1/8	.129	.133	0.465	0.252	0.312	.250	.041	170	220
A46S				0.524	0.312	0.375				
A48S				0.650	0.375	0.500				
A410S				0.776	0.500	0.625				
A52S				0.299	0.063	0.126				
A53S				0.362	0.126	0.187				
A54S	4.0	4.1	4.2	0.425	0.188	0.250	7.95	1.30	1160	1560
A56S	5/32	.160	.164	0.551	0.250	0.375	.312	.051	260	350
A58S				0.673	0.375	0.500				
A510S				0.799	0.500	0.625				
A62S				0.327	0.063	0.126				
A63S				0.390	0.126	0.187				
A64S				0.449	0.188	0.250				
A66S				0.575	0.250	0.375				
A68S	4.8	4.9	5.0	0.701	0.375	0.500	9.50	1.55	1700	2230
A610S	3/16	.192	.196	0.827	0.500	0.625	.375	.061	380	500
A612S				0.949	0.625	0.750				
A614S				1.075	0.750	0.875				
A616S				1.201	0.875	1.000				
A618S				1.327	1.000	1.125				
A82S				0.374	0.063	0.126				
A84S				0.500	0.188	0.250				
A86S				0.626	0.250	0.375				
A88S	6.4	6.5	6.6	0.748	0.375	0.500	12.70	2.05	3120	4100
A810S	1/4	.257	.261	0.874	0.500	0.625	.500	.081	700	920
A812S				1.000	0.625	0.750				
A814S				1.122	0.750	0.875				
A816S				1.248	0.875	1.000				

**ALUMINUM BODY  
STEEL MANDREL**

**ISO 9001 Certified  
Made according to IFI Specifications**

Material  
Body 5056 (AlMg5)  
Mandrel Carbon Steel

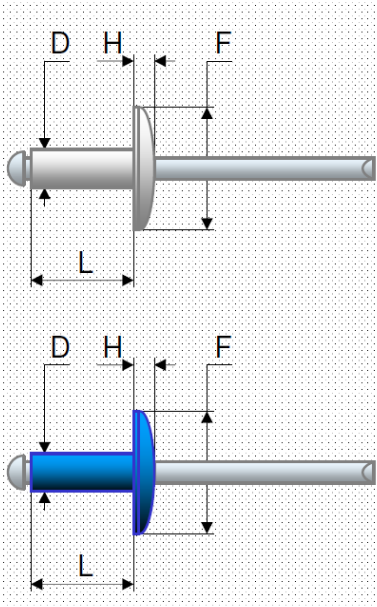

Body Polished  
Colour Painted  
Mandrel Zinc Plating

**Recommended Drill/Hole  
Size**

1/8" dia. rivet #30  
5/32" dia. rivet #20  
3/16" dia. rivet #11  
1/4" dia. rivet F

Rivet Code	D		Hole Dia		L	Grip Range		F	H	Typical Ultimate Strength	
	mm	inch	mm	inch		inch	min.			max.	mm
	nom		min	max				nom	max	N lbs	N lbs
AL42S					0.276	0.063	0.126				
AL43S					0.339	0.126	0.189				
AL44S					0.402	0.189	0.252				
AL45S	3.2	1/8	3.3	3.4	0.465	0.252	0.312	9.50	1.65	760	980
AL46S			.129	.133	0.524	0.312	0.375	.375	.065	170	220
AL48S					0.650	0.375	0.500				
AL410S					0.776	0.500	0.625				
AL52S					0.299	0.063	0.126				
AL53S					0.362	0.126	0.187				
AL54S	4.0	5/32	4.1	4.2	0.425	0.188	0.250	11.90	1.90	1160	1560
AL56S			.160	.164	0.551	0.250	0.375	.468	.075	260	350
AL58S					0.673	0.375	0.500				
AL510S					0.799	0.500	0.625				
AL62S					0.327	0.063	0.126				
AL63S					0.390	0.126	0.187				
AL64S					0.449	0.188	0.250				
AL66S					0.575	0.250	0.375				
AL68S	4.8	3/16	4.9	5.0	0.701	0.375	0.500	13.90	2.15	1700	2230
AL610S			.192	.196	0.827	0.500	0.625	.547	.085	380	500
AL612S					0.949	0.625	0.750				
AL614S					1.075	0.750	0.875				
AL616S					1.201	0.875	1.000				
AL618S					1.327	1.000	1.125				

**ALUMINUM BODY  
STEEL MANDREL**

**ISO 9001 Certified  
Made according to IFI Specifications**

Material  
Body 5056 (AlMg5)  
Mandrel Carbon Steel

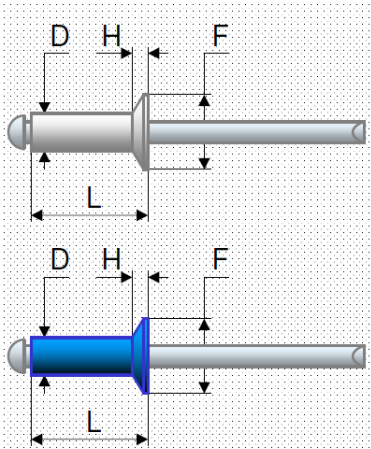

Finishes  
Body Polished  
Colour Painted  
Mandrel Zinc Plating

Recommended Drill/Hole Size		
1/8" dia. rivet	#30	
5/32" dia. rivet	#20	
3/16" dia. rivet	#11	
1/4" dia. rivet	F	

Rivet Code	D mm inch nom	Hole Dia mm inch		L inch	Grip Range inch		F mm inch nom	H mm inch max	Typical Ultimate Strength	
		min	max		min.	max.			Shear N lbs	Tensile N lbs
AC32S	2.4	2.5	2.6	0.252	0.063	0.126	4.75	0.80	400	535
AC34S	3/32	.097	.101	0.374	0.126	0.250	.188	.032	90	120
AC36S				0.500	0.250	0.375				
AC42S				0.276	0.063	0.126				
AC43S				0.339	0.126	0.189				
AC44S	3.2	3.3	3.4	0.402	0.189	0.252	5.60	1.05	760	980
AC45S	1/8	.129	.133	0.465	0.252	0.312	.220	.041	170	220
AC46S				0.524	0.312	0.375				
AC48S				0.650	0.375	0.500				
AC52S				0.299	0.063	0.126				
AC53S				0.362	0.126	0.187				
AC54S	4.0	4.1	4.2	0.425	0.188	0.250	7.15	1.30	1160	1560
AC56S	5/32	.160	.164	0.551	0.250	0.375	.281	.051	260	350
AC58S				0.673	0.375	0.500				
AC510S				0.799	0.500	0.625				
AC62S				0.327	0.063	0.126				
AC63S				0.390	0.126	0.187				
AC64S	4.8	4.9	5.0	0.449	0.188	0.250	8.85	1.55	1700	2230
AC66S	3/16	.192	.196	0.575	0.250	0.375	.348	.061	380	500
AC68S				0.701	0.375	0.500				
AC610S				0.827	0.500	0.625				
AC84S				0.500	0.188	0.250				
AC86S				0.626	0.250	0.375				
AC88S	6.4	6.5	6.6	0.748	0.375	0.500	12.00	2.05	3120	4100
AC810S	1/4	.257	.261	0.874	0.500	0.625	.472	.081	700	920
AC812S				1.000	0.625	0.750				

# GPF SYSTEMS

# OPEN-END BLIND RIVET

## ALUMINUM BODY STAINLESS STEEL MANDREL

ISO 9001 Certified  
Made according to IFI Specifications

Material  
Body 5056 (AlMg5)  
Mandrel 300 Series

Stainless Steel

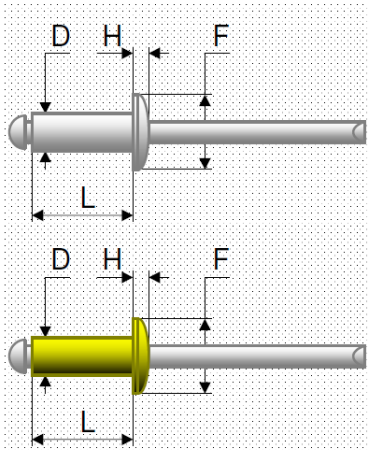

Finishes

Body Polished  
Colour Painted  
Mandrel Polished

### Recommended Drill/Hole Size

1/8" dia. rivet #30  
5/32" dia. rivet #20  
3/16" dia. rivet #11  
1/4" dia. rivet F

Rivet Code	D mm inch nom	Hole Dia mm inch		L inch	Grip Range inch		F mm inch nom	H mm inch max	Typical Ultimate Strength	
		min	max		min.	max.			Shear N lbs	Tensile N lbs
A32SS	2.4	2.5	2.6	0.252	0.063	0.126	4.75	0.80	400	535
A34SS	3/32	.097	.101	0.374	0.126	0.250	.188	.032	90	120
A36SS				0.500	0.250	0.375				
A41SS				0.213	0.031	0.063				
A42SS				0.276	0.063	0.126				
A43SS				0.339	0.126	0.189				
A44SS	3.2	3.3	3.4	0.402	0.189	0.252	6.35	1.05	760	980
A45SS	1/8	.129	.133	0.465	0.252	0.312	.250	.041	170	220
A46SS				0.524	0.312	0.375				
A48SS				0.650	0.375	0.500				
A410SS				0.776	0.500	0.625				
A52SS				0.299	0.063	0.126				
A53SS				0.362	0.126	0.187				
A54SS	4.0	4.1	4.2	0.425	0.188	0.250	7.95	1.30	1160	1560
A56SS	5/32	.160	.164	0.551	0.250	0.375	.312	.051	260	350
A58SS				0.673	0.375	0.500				
A510SS				0.799	0.500	0.625				
A62SS				0.327	0.063	0.126				
A63SS				0.390	0.126	0.187				
A64SS				0.449	0.188	0.250				
A66SS				0.575	0.250	0.375				
A68SS	4.8	4.9	5.0	0.701	0.375	0.500	9.50	1.55	1700	2230
A610SS	3/16	.192	.196	0.827	0.500	0.625	.375	.061	380	500
A612SS				0.949	0.625	0.750				
A614SS				1.075	0.750	0.875				
A616SS				1.201	0.875	1.000				
A618SS				1.327	1.000	1.125				
A82SS				0.374	0.063	0.126				
A84SS				0.500	0.188	0.250				
A86SS				0.626	0.250	0.375				
A88SS	6.4	6.5	6.6	0.748	0.375	0.500	12.70	2.05	3120	4100
A810SS	1/4	.257	.261	0.874	0.500	0.625	.500	.081	700	920
A812SS				1.000	0.625	0.750				
A814SS				1.122	0.750	0.875				
A816SS				1.248	0.875	1.000				



**ALUMINUM BODY  
STAINLESS STEEL MANDREL**

**ISO 9001 Certified  
Made according to IFI Specifications**

Material  
Body 5056 (AlMg5)  
Mandrel 300 Series  
Stainless Steel

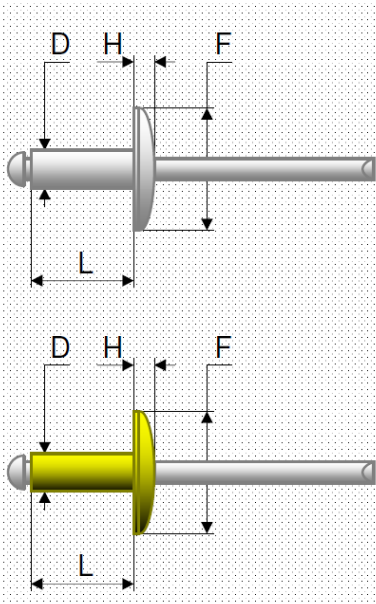

Finishes  
Body Polished  
Colour Painted  
Mandrel Polished

Recommended Drill/Hole Size		
1/8"	dia. rivet	#30
5/32"	dia. rivet	#20
3/16"	dia. rivet	#11
1/4"	dia. rivet	F

Rivet Code	D mm inch nom	Hole Dia mm inch		L inch	Grip Range inch		F mm inch nom	H mm inch max	Typical Ultimate Strength	
		min	max		min.	max.			Shear N lbs	Tensile N lbs
AL42SS				0.276	0.063	0.126				
AL43SS				0.339	0.126	0.189				
AL44SS				0.402	0.189	0.252				
AL45SS	3.2 1/8	3.3 .129	3.4 .133	0.465	0.252	0.312	9.50 .375	1.65 .065	760 170	980 220
AL46SS				0.524	0.312	0.375				
AL48SS				0.650	0.375	0.500				
AL410SS				0.776	0.500	0.625				
AL52SS				0.299	0.063	0.126				
AL53SS				0.362	0.126	0.187				
AL54SS	4.0 5/32	4.1 .160	4.2 .164	0.425	0.188	0.250	11.90 .468	1.90 .075	1160 260	1560 350
AL56SS				0.551	0.250	0.375				
AL58SS				0.673	0.375	0.500				
AL510SS				0.799	0.500	0.625				
AL62SS				0.327	0.063	0.126				
AL63SS				0.390	0.126	0.187				
AL64SS				0.449	0.188	0.250				
AL66SS				0.575	0.250	0.375				
AL68SS	4.8 3/16	4.9 .192	5.0 .196	0.701	0.375	0.500	13.90 .547	2.15 .085	1700 380	2230 500
AL610SS				0.827	0.500	0.625				
AL612SS				0.949	0.625	0.750				
AL614SS				1.075	0.750	0.875				
AL616SS				1.201	0.875	1.000				
AL618SS				1.327	1.000	1.125				

**ALUMINUM BODY  
STAINLESS STEEL MANDREL**

**ISO 9001 Certified  
Made according to IFI Specifications**

Material  
Body 5056 (AlMg5)  
Mandrel 300 Series

Stainless Steel

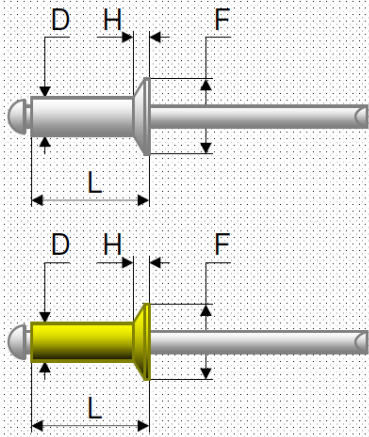

Finishes  
Body Polished  
Colour Painted  
Mandrel Polished

**Recommended Drill/Hole  
Size**

1/8" dia. rivet #30  
5/32" dia. rivet #20  
3/16" dia. rivet #11  
1/4" dia. rivet F

Rivet Code	D mm inch nom	Hole Dia mm inch		L inch	Grip Range inch		F mm inch nom	H mm inch max	Typical Ultimate Strength	
		min	max		min.	max.			Shear N lbs	Tensile N lbs
AC32SS AC34SS AC36SS	2.4 3/32	2.5 .097	2.6 .101	0.252 0.374 0.500	0.063 0.126 0.250	0.126 0.250 0.375	4.75 .188	0.80 .032	400 90	535 120
AC42SS AC43SS AC44SS AC45SS AC46SS AC48SS	3.2 1/8	3.3 .129	3.4 .133	0.276 0.339 0.402 0.465 0.524 0.650	0.063 0.126 0.189 0.252 0.312 0.375	0.126 0.189 0.252 0.312 0.375 0.500	5.60 .220	1.05 .041	760 170	980 220
AC52SS AC53SS AC54SS AC56SS AC58SS AC510SS	4.0 5/32	4.1 .160	4.2 .164	0.299 0.362 0.425 0.551 0.673 0.799	0.063 0.126 0.188 0.250 0.375 0.500	0.126 0.187 0.250 0.375 0.500 0.625	7.15 .281	1.30 .051	1160 260	1560 350
AC62SS AC63SS AC64SS AC66SS AC68SS AC610SS	4.8 3/16	4.9 .192	5.0 .196	0.327 0.390 0.449 0.575 0.701 0.827	0.063 0.126 0.188 0.250 0.375 0.500	0.126 0.187 0.250 0.375 0.500 0.625	8.85 .348	1.55 .061	1700 380	2230 500
AC84SS AC86SS AC88SS AC810SS AC812SS	6.4 1/4	6.5 .257	6.6 .261	0.500 0.626 0.748 0.874 1.000	0.188 0.250 0.375 0.500 0.625	0.250 0.375 0.500 0.625 0.750	12.00 .472	2.05 .081	3120 700	4100 920

**STEEL BODY  
STEEL MANDREL**

**ISO 9001 Certified  
Made according to IFI Specifications**

Material  
Body Low Carbon Steel  
Mandrel Carbon Steel

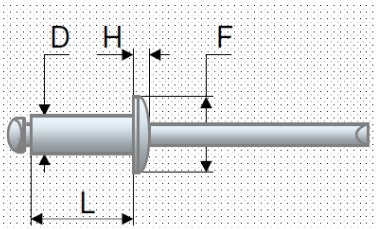

Finishes  
Body Zinc Plating  
Mandrel Zinc Plating

Recommended Drill/Hole Size		
1/8" dia. rivet	#30	
5/32" dia. rivet	#20	
3/16" dia. rivet	#11	
1/4" dia. rivet	F	

Rivet Code	D mm inch nom	Hole Dia mm inch		L inch	Grip Range inch		F mm inch nom	H mm inch max	Typical Ultimate Strength	
		min	max		min.	max.			Shear N lbs	Tensile N lbs
S32S	2.4	2.5	2.6	0.252	0.063	0.126	4.75	0.80	580	760
S34S	3/32	.097	.101	0.374	0.126	0.250	.188	.032	130	170
S36S				0.500	0.250	0.375				
S41S				0.213	0.031	0.063				
S42S				0.276	0.063	0.126				
S43S				0.339	0.126	0.189				
S44S	3.2	3.3	3.4	0.402	0.189	0.252	6.35	1.05	1160	1380
S45S	1/8	.129	.133	0.465	0.252	0.312	.250	.041	260	310
S46S				0.524	0.312	0.375				
S48S				0.650	0.375	0.500				
S410S				0.776	0.500	0.625				
S52S				0.299	0.063	0.126				
S53S				0.362	0.126	0.187				
S54S	4.0	4.1	4.2	0.425	0.188	0.250	7.95	1.30	1650	2100
S56S	5/32	.160	.164	0.551	0.250	0.375	.312	.051	370	470
S58S				0.673	0.375	0.500				
S510S				0.799	0.500	0.625				
S62S				0.327	0.063	0.126				
S63S				0.390	0.126	0.187				
S64S				0.449	0.188	0.250				
S66S				0.575	0.250	0.375				
S68S	4.8	4.9	5.0	0.701	0.375	0.500	9.50	1.55	2400	3030
S610S	3/16	.192	.196	0.827	0.500	0.625	.375	.061	540	680
S612S				0.949	0.625	0.750				
S614S				1.075	0.750	0.875				
S616S				1.201	0.875	1.000				
S618S				1.327	1.000	1.125				
S82S				0.374	0.063	0.126				
S84S				0.500	0.188	0.250				
S86S				0.626	0.250	0.375				
S88S	6.4	6.5	6.6	0.748	0.375	0.500	12.70	2.05	4450	5520
S810S	1/4	.257	.261	0.874	0.500	0.625	.500	.081	1000	1240
S812S				1.000	0.625	0.750				
S814S				1.122	0.750	0.875				
S816S				1.248	0.875	1.000				

**STEEL BODY  
STEEL MANDREL**

**ISO 9001 Certified  
Made according to IFI Specifications**

Material  
Body Low Carbon Steel  
Mandrel Carbon Steel

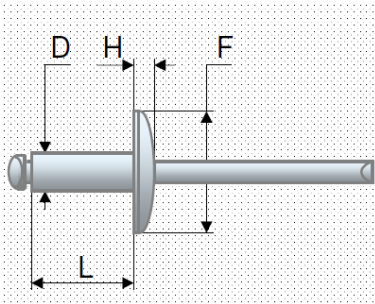

Finishes  
Body Zinc Plating  
Mandrel Zinc Plating

**Recommended Drill/Hole  
Size**

1/8" dia. rivet #30  
5/32" dia. rivet #20  
3/16" dia. rivet #11  
1/4" dia. rivet F

Rivet Code	D mm inch nom	Hole Dia mm inch		L inch	Grip Range inch		F mm inch nom	H mm inch max	Typical Ultimate Strength	
		min	max		min.	max.			Shear N lbs	Tensile N lbs
SL42S				0.276	0.063	0.126				
SL43S				0.339	0.126	0.189				
SL44S	3.2	3.3	3.4	0.402	0.189	0.252	9.50	1.65	1160	1380
SL45S	1/8	.129	.133	0.465	0.252	0.312	.375	.065	260	310
SL46S				0.524	0.312	0.375				
SL48S				0.650	0.375	0.500				
SL410S				0.776	0.500	0.625				
SL52S				0.299	0.063	0.126				
SL53S				0.362	0.126	0.187				
SL54S	4.0	4.1	4.2	0.425	0.188	0.250	11.90	1.90	1650	2100
SL56S	5/32	.160	.164	0.551	0.250	0.375	.468	.075	370	470
SL58S				0.673	0.375	0.500				
SL510S				0.799	0.500	0.625				
SL63S				0.390	0.126	0.187				
SL64S				0.449	0.188	0.250				
SL66S				0.575	0.250	0.375				
SL68S	4.8	4.9	5.0	0.701	0.375	0.500	13.90	2.15	2400	3030
SL610S	3/16	.192	.196	0.827	0.500	0.625	.547	.085	540	680
SL612S				0.949	0.625	0.750				
SL614S				1.075	0.750	0.875				
SL616S				1.201	0.875	1.000				
SL618S				1.327	1.000	1.125				
SXL63S				0.390	0.126	0.187				
SXL64S				0.449	0.188	0.250				
SXL66S				0.575	0.250	0.375				
SXL68S	4.8	4.9	5.0	0.701	0.375	0.500	15.90	2.35	2400	3030
SXL610S	3/16	.192	.196	0.827	0.500	0.625	.625	.092	540	680
SXL612S				0.949	0.625	0.750				
SXL614S				1.075	0.750	0.875				
SXL616S				1.201	0.875	1.000				
SXL618S				1.327	1.000	1.125				



**STEEL BODY  
STEEL MANDREL**

**ISO 9001 Certified  
Made according to IFI Specifications**

Material  
Body Low Carbon Steel  
Mandrel Carbon Steel

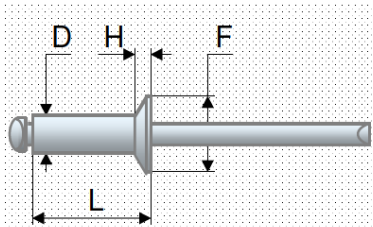

Finishes  
Body Zinc Plating  
Mandrel Zinc Plating

Recommended Drill/Hole Size		
1/8" dia. rivet	#30	
5/32" dia. rivet	#20	
3/16" dia. rivet	#11	
1/4" dia. rivet	F	

Rivet Code	D mm inch nom	Hole Dia mm inch		L inch	Grip Range inch		F mm inch nom	H mm inch max	Typical Ultimate Strength	
		min	max		min.	max.			Shear N lbs	Tensile N lbs
SC32S	2.4	2.5	2.6	0.252	0.063	0.126	4.75	0.80	580	760
SC34S	3/32	.097	.101	0.374	0.126	0.250	.188	.032	130	170
SC36S				0.500	0.250	0.375				
SC42S				0.276	0.063	0.126				
SC43S				0.339	0.126	0.189				
SC44S	3.2	3.3	3.4	0.402	0.189	0.252	5.60	1.05	1160	1380
SC45S	1/8	.129	.133	0.465	0.252	0.312	.220	.041	260	310
SC46S				0.524	0.312	0.375				
SC48S				0.650	0.375	0.500				
SC52S				0.299	0.063	0.126				
SC53S				0.362	0.126	0.187				
SC54S	4.0	4.1	4.2	0.425	0.188	0.250	7.15	1.30	1650	2100
SC56S	5/32	.160	.164	0.551	0.250	0.375	.281	.051	370	470
SC58S				0.673	0.375	0.500				
SC510S				0.799	0.500	0.625				
SC62S				0.327	0.063	0.126				
SC63S				0.390	0.126	0.187				
SC64S	4.8	4.9	5.0	0.449	0.188	0.250	8.85	1.55	2400	3030
SC66S	3/16	.192	.196	0.575	0.250	0.375	.348	.061	540	680
SC68S				0.701	0.375	0.500				
SC610S				0.827	0.500	0.625				
SC84S				0.500	0.188	0.250				
SC86S				0.626	0.250	0.375				
SC88S	6.4	6.5	6.6	0.748	0.375	0.500	12.00	2.05	4450	5520
SC810S	1/4	.257	.261	0.874	0.500	0.625	.472	.081	1000	1240
SC812S				1.000	0.625	0.750				

# GPF SYSTEMS

# OPEN-END BLIND RIVET

## STAINLESS STEEL BODY STAINLESS STEEL MANDREL

ISO 9001 Certified  
Made according to IFI Specifications

Material  
Body 300 Series  
Stainless Steel  
Mandrel 300 Series  
Stainless Steel

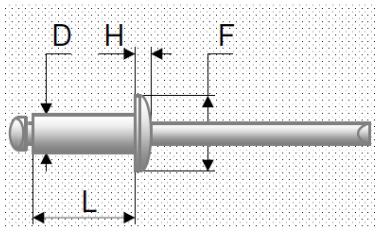

Finishes  
Body Polished  
Mandrel Polished

Recommended Drill/Hole Size		
1/8" dia. rivet	#30	
5/32" dia. rivet	#20	
3/16" dia. rivet	#11	
1/4" dia. rivet	F	

Rivet Code	D mm inch nom	Hole Dia mm inch		L inch	Grip Range inch		F mm inch nom	H mm inch max	Typical Ultimate Strength	
		min	max		min.	max.			Shear N lbs	Tensile N lbs
SS32SS	2.4	2.5	2.6	0.252	0.063	0.126	4.75	0.80	580	760
SS34SS	3/32	.097	.101	0.374	0.126	0.250	.188	.032	130	170
SS36SS				0.500	0.250	0.375				
SS41SS				0.213	0.031	0.063				
SS42SS				0.276	0.063	0.126				
SS43SS				0.339	0.126	0.189				
SS44SS	3.2	3.3	3.4	0.402	0.189	0.252	6.35	1.05	1870	2360
SS45SS	1/8	.129	.133	0.465	0.252	0.312	.250	.041	420	530
SS46SS				0.524	0.312	0.375				
SS48SS				0.650	0.375	0.500				
SS410SS				0.776	0.500	0.625				
SS52SS				0.299	0.063	0.126				
SS53SS				0.362	0.126	0.187				
SS54SS	4.0	4.1	4.2	0.425	0.188	0.250	7.95	1.30	2900	3650
SS56SS	5/32	.160	.164	0.551	0.250	0.375	.312	.051	650	820
SS58SS				0.673	0.375	0.500				
SS510SS				0.799	0.500	0.625				
SS62SS				0.327	0.063	0.126				
SS63SS				0.390	0.126	0.187				
SS64SS				0.449	0.188	0.250				
SS66SS				0.575	0.250	0.375				
SS68SS	4.8	4.9	5.0	0.701	0.375	0.500	9.50	1.55	4230	5340
SS610SS	3/16	.192	.196	0.827	0.500	0.625	.375	.061	950	1200
SS612SS				0.949	0.625	0.750				
SS614SS				1.075	0.750	0.875				
SS616SS				1.201	0.875	1.000				
SS618SS				1.327	1.000	1.125				
SS82SS				0.374	0.063	0.126				
SS84SS				0.500	0.188	0.250				
SS86SS				0.626	0.250	0.375				
SS88SS	6.4	6.5	6.6	0.748	0.375	0.500	12.70	2.05	7570	9350
SS810SS	1/4	.257	.261	0.874	0.500	0.625	.500	.081	1700	2100
SS812SS				1.000	0.625	0.750				
SS814SS				1.122	0.750	0.875				
SS816SS				1.248	0.875	1.000				

# GPF SYSTEMS

# OPEN-END BLIND RIVET

## STAINLESS STEEL BODY STAINLESS STEEL MANDREL

ISO 9001 Certified  
Made according to IFI Specifications

Material  
Body 300 Series  
Stainless Steel  
Mandrel 300 Series  
Stainless Steel

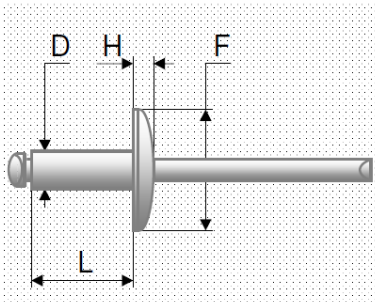

Finishes  
Body Polished  
Mandrel Polished

### Recommended Drill/Hole Size

1/8" dia. rivet	#30
5/32" dia. rivet	#20
3/16" dia. rivet	#11
1/4" dia. rivet	F

Rivet Code	D mm inch nom	Hole Dia mm inch		L inch	Grip Range inch		F mm inch nom	H mm inch max	Typical Ultimate Strength	
		min	max		min.	max.			Shear N lbs	Tensile N lbs
SSL42SS				0.276	0.063	0.126				
SSL43SS				0.339	0.126	0.189				
SSL44SS	3.2	3.3	3.4	0.402	0.189	0.252	9.50	1.65	1870	2360
SSL45SS	1/8	.129	.133	0.465	0.252	0.312	.375	.065	420	530
SSL46SS				0.524	0.312	0.375				
SSL48SS				0.650	0.375	0.500				
SSL52SS				0.299	0.063	0.126				
SSL53SS				0.362	0.126	0.187				
SSL54SS	4.0	4.1	4.2	0.425	0.188	0.250	11.90	1.90	2900	3650
SSL56SS	5/32	.160	.164	0.551	0.250	0.375	.468	.075	650	820
SSL58SS				0.673	0.375	0.500				
SSL510SS				0.799	0.500	0.625				
SSL63SS				0.390	0.126	0.187				
SSL64SS				0.449	0.188	0.250				
SSL66SS				0.575	0.250	0.375				
SSL68SS				0.701	0.375	0.500				
SSL610SS	4.8	4.9	5.0	0.827	0.500	0.625	13.90	2.15	4230	5340
SSL612SS	3/16	.192	.196	0.949	0.625	0.750	.547	.085	950	1200
SSL614SS				1.075	0.750	0.875				
SSL616SS				1.201	0.875	1.000				
SSL618SS				1.327	1.000	1.125				
SSXL63SS				0.390	0.126	0.187				
SSXL64SS				0.449	0.188	0.250				
SSXL66SS				0.575	0.250	0.375				
SSXL68SS				0.701	0.375	0.500				
SSXL610SS	4.8	4.9	5.0	0.827	0.500	0.625	15.90	2.35	4230	5340
SSXL612SS	3/16	.192	.196	0.949	0.625	0.750	.625	.092	950	1200
SSXL614SS				1.075	0.750	0.875				
SSXL616SS				1.201	0.875	1.000				
SSXL618SS				1.327	1.000	1.125				

**STAINLESS STEEL BODY  
STAINLESS STEEL MANDREL**

**ISO 9001 Certified  
Made according to IFI Specifications**

Material  
Body 300 Series  
Stainless Steel  
Mandrel 300 Series  
Stainless Steel

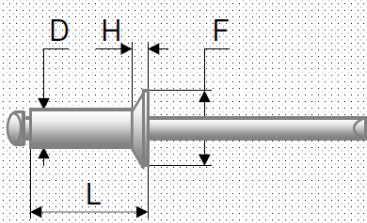

Finishes  
Body Polished  
Mandrel Polished

Recommended Drill/Hole Size		
1/8" dia. rivet	#30	
5/32" dia. rivet	#20	
3/16" dia. rivet	#11	
1/4" dia. rivet	F	

Rivet Code	D mm inch nom	Hole Dia mm inch		L inch	Grip Range inch		F mm inch nom	H mm inch max	Typical Ultimate Strength	
		min	max		min.	max.			Shear N lbs	Tensile N lbs
SSC32SS	2.4	2.5	2.6	0.252	0.063	0.126	4.75	0.80	580	760
SSC34SS	3/32	.097	.101	0.374	0.126	0.250	.188	.032	130	170
SSC36SS				0.500	0.250	0.375				
SSC42SS				0.276	0.063	0.126				
SSC43SS				0.339	0.126	0.189				
SSC44SS	3.2	3.3	3.4	0.402	0.189	0.252	5.60	1.05	1870	2360
SSC45SS	1/8	.129	.133	0.465	0.252	0.312	.220	.041	420	530
SSC46SS				0.524	0.312	0.375				
SSC48SS				0.650	0.375	0.500				
SSC52SS				0.299	0.063	0.126				
SSC53SS				0.362	0.126	0.187				
SSC54SS	4.0	4.1	4.2	0.425	0.188	0.250	7.15	1.30	2900	3650
SSC56SS	5/32	.160	.164	0.551	0.250	0.375	.281	.051	650	820
SSC58SS				0.673	0.375	0.500				
SSC510SS				0.799	0.500	0.625				
SSC62SS				0.327	0.063	0.126				
SSC63SS				0.390	0.126	0.187				
SSC64SS	4.8	4.9	5.0	0.449	0.188	0.250	8.85	1.55	4230	5340
SSC66SS	3/16	.192	.196	0.575	0.250	0.375	.348	.061	950	1200
SSC68SS				0.701	0.375	0.500				
SSC610SS				0.827	0.500	0.625				



**STAINLESS STEEL BODY  
STEEL MANDREL**

**ISO 9001 Certified  
Made according to IFI Specifications**

Material  
Body 300 Series  
Stainless Steel  
Mandrel Carbon Steel

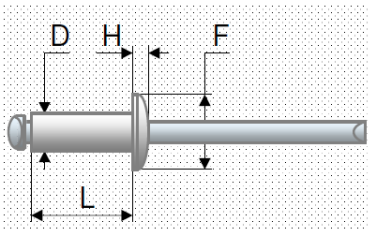

Finishes  
Body Polished  
Mandrel Zinc Plating

**Recommended Drill/Hole  
Size**

1/8" dia. rivet #30  
5/32" dia. rivet #20  
3/16" dia. rivet #11  
1/4" dia. rivet F

Rivet Code	D mm inch nom	Hole Dia mm inch		L inch	Grip Range inch		F mm inch nom	H mm inch max	Typical Ultimate Strength	
		min	max		min.	max.			Shear N lbs	Tensile N lbs
SS41S				0.213	0.031	0.063				
SS42S				0.276	0.063	0.126				
SS43S				0.339	0.126	0.189				
SS44S	3.2 1/8	3.3 .129	3.4 .133	0.402	0.189	0.252	6.35 .250	1.05 .041	1870 420	2360 530
SS45S				0.465	0.252	0.312				
SS46S				0.524	0.312	0.375				
SS48S				0.650	0.375	0.500				
SS410S				0.776	0.500	0.625				
SS52S				0.299	0.063	0.126				
SS53S				0.362	0.126	0.187				
SS54S	4.0	4.1	4.2	0.425	0.188	0.250	7.95	1.30	2900	3650
SS56S	5/32	.160	.164	0.551	0.250	0.375	.312	.051	650	820
SS58S				0.673	0.375	0.500				
SS510S				0.799	0.500	0.625				
SS62S				0.327	0.063	0.126				
SS63S				0.390	0.126	0.187				
SS64S				0.449	0.188	0.250				
SS66S				0.575	0.250	0.375				
SS68S	4.8	4.9	5.0	0.701	0.375	0.500	9.50	1.55	4230	5340
SS610S	3/16	.192	.196	0.827	0.500	0.625	.375	.061	950	1200
SS612S				0.949	0.625	0.750				
SS614S				1.075	0.750	0.875				
SS616S				1.201	0.875	1.000				
SS618S				1.327	1.000	1.125				
SS82S				0.374	0.063	0.126				
SS84S				0.500	0.188	0.250				
SS86S				0.626	0.250	0.375				
SS88S	6.4	6.5	6.6	0.748	0.375	0.500	12.70	2.05	7570	9350
SS810S	1/4	.257	.261	0.874	0.500	0.625	.500	.081	1700	2100
SS812S				1.000	0.625	0.750				
SS814S				1.122	0.750	0.875				
SS816S				1.248	0.875	1.000				

**STAINLESS STEEL BODY  
STEEL MANDREL**

**ISO 9001 Certified  
Made according to IFI Specifications**

Material  
Body 300 Series  
Stainless Steel  
Mandrel Carbon Steel

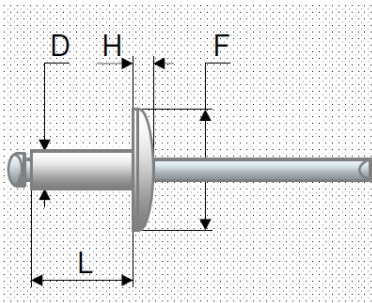

Finishes  
Body Polished  
Mandrel Zinc Plating

**Recommended Drill/Hole  
Size**

1/8" dia. rivet #30  
5/32" dia. rivet #20  
3/16" dia. rivet #11  
1/4" dia. rivet F

Rivet Code	D mm inch nom	Hole Dia mm inch		L inch	Grip Range inch		F mm inch nom	H mm inch max	Typical Ultimate Strength	
		min	max		min.	max.			Shear N lbs	Tensile N lbs
SSL42S				0.276	0.063	0.126				
SSL43S				0.339	0.126	0.189				
SSL44S	3.2	3.3	3.4	0.402	0.189	0.252	9.50	1.65	1870	2360
SSL45S	1/8	.129	.133	0.465	0.252	0.312	.375	.065	420	530
SSL46S				0.524	0.312	0.375				
SSL48S				0.650	0.375	0.500				
SSL52S				0.299	0.063	0.126				
SSL53S				0.362	0.126	0.187				
SSL54S	4.0	4.1	4.2	0.425	0.188	0.250	11.90	1.90	2900	3650
SSL56S	5/32	.160	.164	0.551	0.250	0.375	.468	.075	650	820
SSL58S				0.673	0.375	0.500				
SSL510S				0.799	0.500	0.625				
SSL63S				0.390	0.126	0.187				
SSL64S				0.449	0.188	0.250				
SSL66S				0.575	0.250	0.375				
SSL68S				0.701	0.375	0.500				
SSL610S	4.8	4.9	5.0	0.827	0.500	0.625	13.90	2.15	4230	5340
SSL612S	3/16	.192	.196	0.949	0.625	0.750	.547	.085	950	1200
SSL614S				1.075	0.750	0.875				
SSL616S				1.201	0.875	1.000				
SSL618S				1.327	1.000	1.125				
SSXL63S				0.390	0.126	0.187				
SSXL64S				0.449	0.188	0.250				
SSXL66S				0.575	0.250	0.375				
SSXL68S				0.701	0.375	0.500				
SSXL610S	4.8	4.9	5.0	0.827	0.500	0.625	15.90	2.35	4230	5340
SSXL612S	3/16	.192	.196	0.949	0.625	0.750	.625	.092	950	1200
SSXL614S				1.075	0.750	0.875				
SSXL616S				1.201	0.875	1.000				
SSXL618S				1.327	1.000	1.125				

**STAINLESS STEEL BODY  
STEEL MANDREL**

**ISO 9001 Certified  
Made according to IFI Specifications**

Material  
Body 300 Series  
Stainless Steel  
Mandrel Carbon Steel

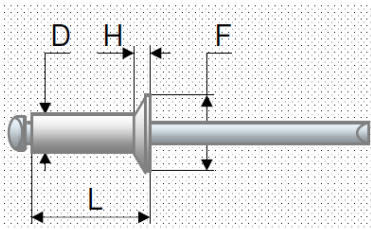

Finishes  
Body Polished  
Mandrel Zinc Plating

Recommended Drill/Hole Size		
1/8" dia. rivet	#30	
5/32" dia. rivet	#20	
3/16" dia. rivet	#11	
1/4" dia. rivet	F	

Rivet Code	D mm inch nom	Hole Dia mm inch		L inch	Grip Range inch		F mm inch nom	H mm inch max	Typical Ultimate Strength	
		min	max		min.	max.			Shear N lbs	Tensile N lbs
SSC32S	2.4 3/32	2.5 .097	2.6 .101	0.252	0.063	0.126	4.75 .188	0.80 .032	580 130	760 170
SSC34S				0.374	0.126	0.250				
SSC36S				0.500	0.250	0.375				
SSC42S	3.2 1/8	3.3 .129	3.4 .133	0.276	0.063	0.126	5.60 .220	1.05 .041	1870 420	2360 530
SSC43S				0.339	0.126	0.189				
SSC44S				0.402	0.189	0.252				
SSC45S				0.465	0.252	0.312				
SSC46S				0.524	0.312	0.375				
SSC48S				0.650	0.375	0.500				
SSC52S	4.0 5/32	4.1 .160	4.2 .164	0.299	0.063	0.126	7.15 .281	1.30 .051	2900 650	3650 820
SSC53S				0.362	0.126	0.187				
SSC54S				0.425	0.188	0.250				
SSC56S				0.551	0.250	0.375				
SSC58S				0.673	0.375	0.500				
SSC510S	0.799	0.500	0.625							
SSC62S	4.8 3/16	4.9 .192	5.0 .196	0.327	0.063	0.126	8.85 .348	1.55 .061	4230 950	5340 1200
SSC63S				0.390	0.126	0.187				
SSC64S				0.449	0.188	0.250				
SSC66S				0.575	0.250	0.375				
SSC68S				0.701	0.375	0.500				
SSC610S				0.827	0.500	0.625				

**COPPER BODY  
STAINLESS STEEL MANDREL**

**ISO 9001 Certified  
Made according to IFI Specifications**

Material  
Body Copper  
Mandrel Carbon Steel

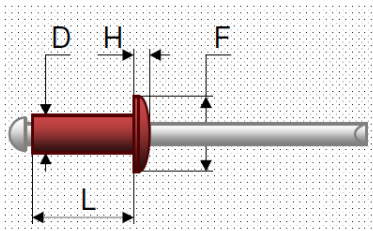

Finishes  
Body Polished  
Mandrel Zinc Plating

Recommended Drill/Hole Size		
1/8" dia. rivet	#30	
5/32" dia. rivet	#20	
3/16" dia. rivet	#11	
1/4" dia. rivet	F	

Rivet Code	D mm inch nom	Hole Dia mm inch		L inch	Grip Range inch		F mm inch nom	H mm inch max	Typical Ultimate Strength	
		min	max		min.	max.			Shear N lbs	Tensile N lbs
C42SS				0.276	0.063	0.126				
C43SS				0.339	0.126	0.189				
C44SS	3.2	3.3	3.4	0.402	0.189	0.252	6.35	1.05	700	800
C45SS	1/8	.129	.133	0.465	0.252	0.312	.250	.041	157	180
C46SS				0.524	0.312	0.375				
C48SS				0.650	0.375	0.500				
C410SS				0.776	0.500	0.625				
C52SS				0.299	0.063	0.126				
C53SS				0.362	0.126	0.187				
C54SS	4.0	4.1	4.2	0.425	0.188	0.250	7.95	1.30	1000	1500
C56SS	5/32	.160	.164	0.551	0.250	0.375	.312	.051	225	337
C58SS				0.673	0.375	0.500				
C510SS				0.799	0.500	0.625				
C62SS				0.327	0.063	0.126				
C63SS				0.390	0.126	0.187				
C64SS				0.449	0.188	0.250				
C66SS				0.575	0.250	0.375				
C68SS	4.8	4.9	5.0	0.701	0.375	0.500	9.50	1.55	1500	2000
C610SS	3/16	.192	.196	0.827	0.500	0.625	.375	.061	337	450
C612SS				0.949	0.625	0.750				
C614SS				1.075	0.750	0.875				
C616SS				1.201	0.875	1.000				
C618SS				1.327	1.000	1.125				



**COPPER BODY  
STEEL MANDREL**

**ISO 9001 Certified  
Made according to IFI Specifications**

Material  
Body Copper  
Mandrel Carbon Steel

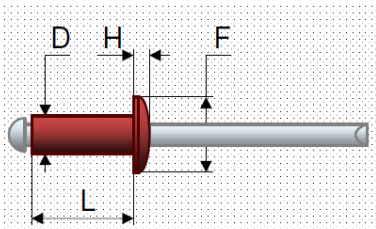

Finishes  
Body Polished  
Mandrel Zinc Plating

Recommended Drill/Hole Size		
1/8"	dia. rivet	#30
5/32"	dia. rivet	#20
3/16"	dia. rivet	#11
1/4"	dia. rivet	F

Rivet Code	D mm inch nom	Hole Dia mm inch		L inch	Grip Range inch		F mm inch nom	H mm inch max	Typical Ultimate Strength	
		min	max		min.	max.			Shear N lbs	Tensile N lbs
C41S				0.213	0.031	0.063				
C42S				0.276	0.063	0.126				
C43S				0.339	0.126	0.189				
C44S	3.2 1/8	3.3 .129	3.4 .133	0.402	0.189	0.252	6.35 .250	1.05 .041	700 157	800 180
C45S				0.465	0.252	0.312				
C46S				0.524	0.312	0.375				
C48S				0.650	0.375	0.500				
C410S				0.776	0.500	0.625				
C52S				0.299	0.063	0.126				
C53S				0.362	0.126	0.187				
C54S	4.0	4.1	4.2	0.425	0.188	0.250	7.95	1.30	1000	1500
C56S	5/32	.160	.164	0.551	0.250	0.375	.312	.051	225	337
C58S				0.673	0.375	0.500				
C510S				0.799	0.500	0.625				
C62S				0.327	0.063	0.126				
C63S				0.390	0.126	0.187				
C64S				0.449	0.188	0.250				
C66S				0.575	0.250	0.375				
C68S	4.8	4.9	5.0	0.701	0.375	0.500	9.50	1.55	1500	2000
C610S	3/16	.192	.196	0.827	0.500	0.625	.375	.061	337	450
C612S				0.949	0.625	0.750				
C614S				1.075	0.750	0.875				
C616S				1.201	0.875	1.000				
C618S				1.327	1.000	1.125				

**MONEL BODY  
STEEL MANDREL**

**ISO 9001 Certified  
Made according to IFI Specifications**

Material  
Body 400 Series  
Monel  
Mandrel Carbon Steel

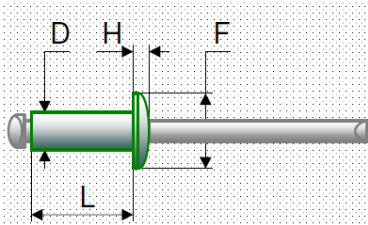

Finishes  
Body Polished  
Mandrel Zinc Plating

**Recommended Drill/Hole  
Size**

1/8" dia. rivet #30  
5/32" dia. rivet #20  
3/16" dia. rivet #11  
1/4" dia. rivet F

Rivet Code	D mm inch nom	Hole Dia mm inch		L inch	Grip Range inch		F mm inch nom	H mm inch max	Typical Ultimate Strength	
		min	max		min.	max.			Shear N lbs	Tensile N lbs
M41S				0.213	0.031	0.063				
M42S				0.276	0.063	0.126				
M43S				0.339	0.126	0.189				
M44S	3.2	3.3	3.4	0.402	0.189	0.252	6.35	1.05	1558	2000
M45S	1/8	.129	.133	0.465	0.252	0.312	.250	.041	350	420
M46S				0.524	0.312	0.375				
M48S				0.650	0.375	0.500				
M410S				0.776	0.500	0.625				
M52S				0.299	0.063	0.126				
M53S				0.362	0.126	0.187				
M54S	4.0	4.1	4.2	0.425	0.188	0.250	7.95	1.30	2448	3115
M56S	5/32	.160	.164	0.551	0.250	0.375	.312	.051	550	700
M58S				0.673	0.375	0.500				
M510S				0.799	0.500	0.625				
M62S				0.327	0.063	0.126				
M63S				0.390	0.126	0.187				
M64S				0.449	0.188	0.250				
M66S	4.8	4.9	5.0	0.575	0.250	0.375	9.50	1.55	3560	4450
M68S	3/16	.192	.196	0.701	0.375	0.500	.375	.061	800	1000
M610S				0.827	0.500	0.625				
M612S				0.949	0.625	0.750				
M82S				0.374	0.063	0.126				
M84S				0.500	0.188	0.250				
M86S				0.626	0.250	0.375				
M88S	6.4	6.5	6.6	0.748	0.375	0.500	12.70	2.05	6230	8233
M810S	1/4	.257	.261	0.874	0.500	0.625	.500	.081	1400	1850
M812S				1.000	0.625	0.750				
M814S				1.122	0.750	0.875				
M816S				1.248	0.875	1.000				

**MONEL BODY  
STEEL MANDREL**

**ISO 9001 Certified  
Made according to IFI Specifications**

Material  
Body 400 Series Monel  
Mandrel Carbon Steel

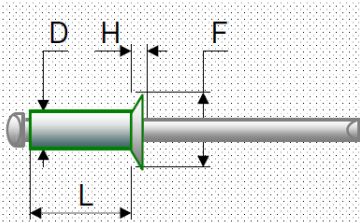

Finishes  
Body Polished  
Mandrel Zinc Plating

**Recommended Drill/Hole  
Size**

1/8" dia. rivet #30  
5/32" dia. rivet #20  
3/16" dia. rivet #11  
1/4" dia. rivet F

Rivet Code	D mm inch nom	Hole Dia mm inch		L inch	Grip Range inch		F mm inch nom	H mm inch max	Typical Ultimate Strength	
		min	max		min.	max.			Shear N lbs	Tensile N lbs
MC42S				0.276	0.063	0.126				
MC43S				0.339	0.126	0.189				
MC44S	3.2	3.3	3.4	0.402	0.189	0.252	5.60	1.05	1558	2000
MC45S	1/8	.129	.133	0.465	0.252	0.312	.220	.041	350	420
MC46S				0.524	0.312	0.375				
MC48S				0.650	0.375	0.500				
MC52S				0.299	0.063	0.126				
MC53S				0.362	0.126	0.187				
MC54S	4.0	4.1	4.2	0.425	0.188	0.250	7.15	1.30	2448	3115
MC56S	5/32	.160	.164	0.551	0.250	0.375	.281	.051	550	700
MC58S				0.673	0.375	0.500				
MC510S				0.799	0.500	0.625				
MC62S				0.327	0.063	0.126				
MC63S				0.390	0.126	0.187				
MC64S	4.8	4.9	5.0	0.449	0.188	0.250	8.85	1.55	3560	4450
MC66S	3/16	.192	.196	0.575	0.250	0.375	.348	.061	800	1000
MC68S				0.701	0.375	0.500				
MC610S				0.827	0.500	0.625				

**MONEL BODY  
STAINLESS STEEL MANDREL**

**ISO 9001 Certified  
Made according to IFI Specifications**

Material  
Body 400 Series  
Monel  
Mandrel Stainless Steel

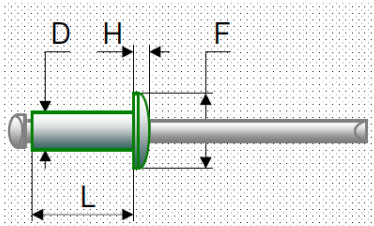

Finishes  
Body Polished  
Mandrel Polished

**Recommended Drill/Hole  
Size**

1/8" dia. rivet	#30
5/32" dia. rivet	#20
3/16" dia. rivet	#11
1/4" dia. rivet	F

Rivet Code	D mm inch nom	Hole Dia mm inch		L inch	Grip Range inch		F mm inch nom	H mm inch max	Typical Ultimate Strength	
		min	max		min.	max.			Shear N lbs	Tensile N lbs
M41SS				0.213	0.031	0.063				
M42SS				0.276	0.063	0.126				
M43SS				0.339	0.126	0.189				
M44SS	3.2	3.3	3.4	0.402	0.189	0.252	6.35	1.05	1558	2000
M45SS	1/8	.129	.133	0.465	0.252	0.312	.250	.041	350	420
M46SS				0.524	0.312	0.375				
M48SS				0.650	0.375	0.500				
M410SS				0.776	0.500	0.625				
M52SS				0.299	0.063	0.126				
M53SS				0.362	0.126	0.187				
M54SS	4.0	4.1	4.2	0.425	0.188	0.250	7.95	1.30	2448	3115
M56SS	5/32	.160	.164	0.551	0.250	0.375	.312	.051	550	700
M58SS				0.673	0.375	0.500				
M510SS				0.799	0.500	0.625				
M62SS				0.327	0.063	0.126				
M63SS				0.390	0.126	0.187				
M64SS	4.8	4.9	5.0	0.449	0.188	0.250	9.50	1.55	3560	4450
M66SS	3/16	.192	.196	0.575	0.250	0.375	.375	.061	800	1000
M68SS				0.701	0.375	0.500				
M610SS				0.827	0.500	0.625				
M612SS				0.949	0.625	0.750				
M82SS				0.374	0.063	0.126				
M84SS				0.500	0.188	0.250				
M86SS				0.626	0.250	0.375				
M88SS	6.4	6.5	6.6	0.748	0.375	0.500	12.70	2.05	6230	8233
M810SS	1/4	.257	.261	0.874	0.500	0.625	.500	.081	1400	1850
M812SS				1.000	0.625	0.750				
M814SS				1.122	0.750	0.875				
M816SS				1.248	0.875	1.000				



**ALUMINIUM BODY  
STEEL MANDREL**

**ISO 9001 Certified  
Made according to IFI Specifications**

Material  
Body 5052 (AlMg2.5)  
Mandrel Carbon Steel

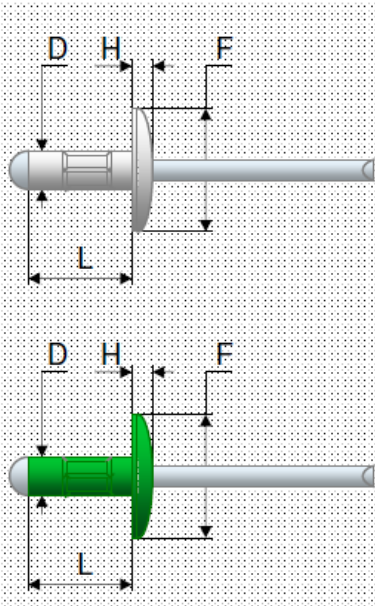

Rivet Code	D mm inch nom	Hole Dia mm inch		L inch	Grip Range inch		F mm inch nom	H mm inch max	Typical Ultimate Strength	
		min	max		min.	max.			Shear N lbs	Tensile N lbs
AMGL43S	3.2 1/8	3.4 .134	3.5 .138	0.366	0.020	0.189	9.50 .375	1.65 .065	600 135	900 202
AMGL44S				0.429	0.063	0.252				
AMGL45S				0.488	0.126	0.311				
AMGL47S				0.614	0.252	0.437				
AMGL54S	4.0 5/32	4.2 .166	4.3 .170	0.449	0.047	0.252	11.90 .468	1.90 .075	950 213	1500 337
AMGL55S				0.508	0.126	0.311				
AMGL56S				0.571	0.189	0.374				
AMGL58S				0.697	0.311	0.500				
AMGL64S	4.8 3/16	5.0 .197	5.1 .201	0.469	0.047	0.252	13.90 .547	2.15 .085	1320 296	2000 450
AMGL66S				0.591	0.126	0.374				
AMGL68S				0.717	0.252	0.500				
AMGL610S				0.843	0.374	0.626				
AMGL612S				0.969	0.500	0.752				
AMGXL64S	4.8 3/16	5.0 .197	5.1 .201	0.469	0.047	0.252	15.90 .625	2.35 .092	1320 296	2000 450
AMGXL66S				0.591	0.126	0.374				
AMGXL68S				0.717	0.252	0.500				
AMGXL610S				0.843	0.374	0.626				
AMGXL612S				0.969	0.500	0.752				

Finishes  
Body Polished  
Colour Painted  
Mandrel Zinc Plating

Recommended Drill/Hole Size	
1/8" dia. rivet	#30
5/32" dia. rivet	#20
3/16" dia. rivet	#11
1/4" dia. rivet	F

**ALUMINIUM BODY  
STAINLESS STEEL MANDREL**

**ISO 9001 Certified  
Made according to IFI Specifications**

Material  
Body 5052 (AlMg2.5)  
Mandrel 300 Series  
Stainless Steel

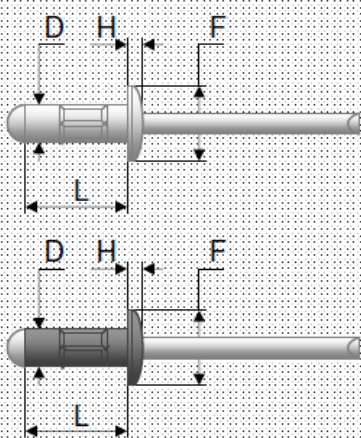

Rivet Code	D mm inch nom	Hole Dia mm inch		L inch	Grip Range inch		F mm inch nom	H mm inch max	Typical Ultimate Strength	
		min	max		min.	max.			Shear N lbs	Tensile N lbs
AMG43SS				0.366	0.020	0.189				
AMG44SS	3.2	3.4	3.5	0.429	0.063	0.252	6.35	1.05	600	900
AMG45SS	1/8	.134	.138	0.488	0.126	0.311	.250	.041	135	202
AMG47SS				0.614	0.252	0.437				
AMG54SS				0.449	0.047	0.252				
AMG55SS	4.0	4.2	4.3	0.508	0.126	0.311	7.95	1.30	950	1500
AMG56SS	5/32	.166	.170	0.571	0.189	0.374	.312	.051	213	337
AMG58SS				0.697	0.311	0.500				
AMG64SS				0.469	0.047	0.252				
AMG66SS	4.8	5.0	5.1	0.591	0.126	0.374	9.50	1.55	1320	2000
AMG68SS	3/16	.197	.201	0.717	0.252	0.500	.375	.061	296	450
AMG610SS				0.843	0.374	0.626				
AMG612SS				0.969	0.500	0.752				

Finishes  
Body Polished  
Colour Painted  
Mandrel Polished

Recommended Drill/Hole Size	
1/8" dia. rivet	#30
5/32" dia. rivet	#20
3/16" dia. rivet	#11
1/4" dia. rivet	F

**ALUMINIUM BODY  
STAINLESS STEEL MANDREL**

**120° Countersunk Head**

Material  
Body 5052 (AlMg2.5)  
Mandrel 300 Series  
Stainless Steel

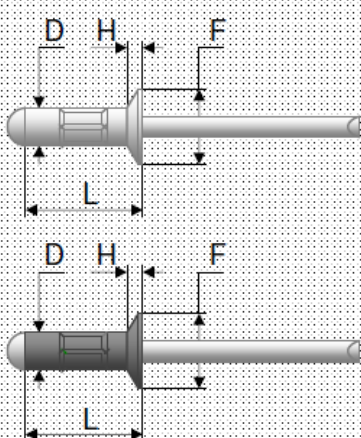

Rivet Code	D mm inch nom	Hole Dia mm inch		L inch	Grip Range inch		F mm inch nom	H mm inch max	Typical Ultimate Strength	
		min	max		min.	max.			Shear N lbs	Tensile N lbs
AMGC44SS				0.429	0.063	0.252				
AMGC45SS	3.2	3.4	3.5	0.488	0.126	0.311	5.60	1.05	600	900
AMGC47SS	1/8	.134	.138	0.614	0.252	0.437	.220	.041	135	202
AMGC54SS				0.449	0.047	0.252				
AMGC55SS	4.0	4.2	4.3	0.508	0.126	0.311	7.15	1.30	950	1500
AMGC56SS	5/32	.166	.170	0.571	0.189	0.374	.281	.051	213	337
AMGC58SS				0.697	0.311	0.500				
AMGC64SS				0.469	0.047	0.252				
AMGC66SS	4.8	5.0	5.1	0.591	0.126	0.374	8.85	1.55	1320	2000
AMGC68SS	3/16	.197	.201	0.717	0.252	0.500	.348	.061	296	450
AMGC610SS				0.843	0.374	0.626				
AMGC612SS				0.969	0.500	0.752				

Finishes Colour Painted  
Body Polished Mandrel Polished

**ALUMINIUM BODY  
STAINLESS STEEL MANDREL**

**ISO 9001 Certified  
Made according to IFI Specifications**

Material

Body 5052 (AlMg2.5)  
Mandrel 300 Series

Stainless Steel

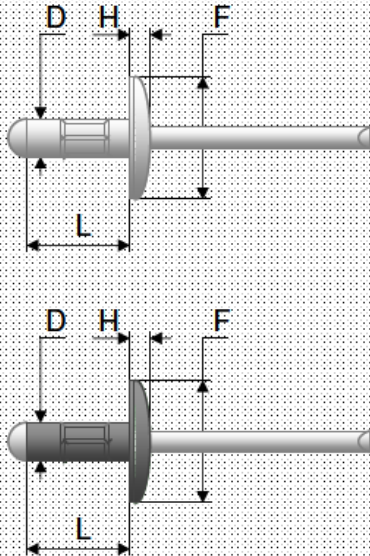

Finishes

Body Polished  
Colour Painted  
Mandrel Polished

Rivet Code	D mm inch nom	Hole Dia mm inch		L inch	Grip Range inch		F mm inch nom	H mm inch max	Typical Ultimate Strength	
		min	max		min.	max.			Shear N lbs	Tensile N lbs
AMGL43SS	3.2 1/8	3.4 .134	3.5 .138	0.366	0.020	0.189	9.50 .375	1.65 .065	600 135	900 202
AMGL44SS				0.429	0.063	0.252				
AMGL45SS				0.488	0.126	0.311				
AMGL47SS				0.614	0.252	0.437				
AMGL54SS	4.0 5/32	4.2 .166	4.3 .170	0.449	0.047	0.252	11.90 .468	1.90 .075	950 213	1500 337
AMGL55SS				0.508	0.126	0.311				
AMGL56SS				0.571	0.189	0.374				
AMGL58SS				0.697	0.311	0.500				
AMGL64SS	4.8 3/16	5.0 .197	5.1 .201	0.469	0.047	0.252	13.90 .547	2.15 .085	1320 296	2000 450
AMGL66SS				0.591	0.126	0.374				
AMGL68SS				0.717	0.252	0.500				
AMGL610SS				0.843	0.374	0.626				
AMGL612SS				0.969	0.500	0.752				
AMGXL64SS	4.8 3/16	5.0 .197	5.1 .201	0.469	0.047	0.252	15.90 .625	2.35 .092	1320 296	2000 450
AMGXL66SS				0.591	0.126	0.374				
AMGXL68SS				0.717	0.252	0.500				
AMGXL610SS				0.843	0.374	0.626				
AMGXL612SS				0.969	0.500	0.752				

**Recommended Drill/Hole  
Size**

1/8" dia. rivet	#30
5/32" dia. rivet	#20
3/16" dia. rivet	#11
1/4" dia. rivet	F



**STEEL BODY  
STEEL MANDREL**

**ISO 9001 Certified  
Made according to IFI Specifications**

Material  
Body Low Carbon Steel  
Mandrel Carbon Steel

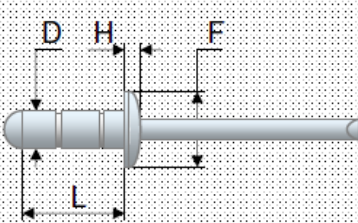

Finishes  
Body Zinc Plating  
Mandrel Zinc Plating

Rivet Code	D mm inch nom	Hole Dia mm inch		L inch	Grip Range inch		F mm inch nom	H mm inch max	Typical Ultimate Strength	
		min	max		min.	max.			Shear N lbs	Tensile N lbs
SMG43S				0.366	0.020	0.189				
SMG44S	3.2	3.4	3.5	0.429	0.063	0.252	6.35	1.05	1160	1380
SMG45S	1/8	.134	.138	0.488	0.126	0.311	.250	.041	260	310
SMG47S				0.614	0.252	0.437				
SMG54S				0.449	0.047	0.252				
SMG55S	4.0	4.2	4.3	0.508	0.126	0.311	7.95	1.30	1650	2100
SMG56S	5/32	.166	.170	0.571	0.189	0.374	.312	.051	370	470
SMG58S				0.697	0.311	0.500				
SMG64S				0.469	0.047	0.252				
SMG66S				0.591	0.126	0.374				
SMG68S	4.8	5.0	5.1	0.717	0.252	0.500	9.50	1.55	2400	3030
SMG610S	3/16	.197	.201	0.843	0.374	0.626	.375	.061	540	680
SMG612S				0.969	0.500	0.752				

**Recommended Drill/Hole Size**

1/8" dia. rivet #30  
5/32" dia. rivet #20  
3/16" dia. rivet #11  
1/4" dia. rivet F

**STEEL BODY  
STEEL MANDREL**

**120° Countersunk Head**

Material  
Body Low Carbon Steel  
Mandrel Carbon Steel

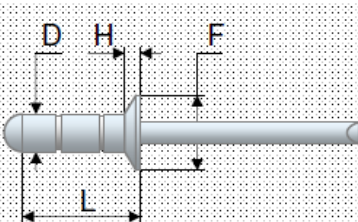

Finishes  
Body Zinc Plating  
Mandrel Zinc Plating

Rivet Code	D mm inch nom	Hole Dia mm inch		L inch	Grip Range inch		F mm inch nom	H mm inch max	Typical Ultimate Strength	
		min	max		min.	max.			Shear N lbs	Tensile N lbs
SMGC44S				0.429	0.063	0.252				
SMGC45S	3.2	3.4	3.5	0.488	0.126	0.311	5.60	1.05	1160	1380
SMGC47S	1/8	.134	.138	0.614	0.252	0.437	.220	.041	260	310
SMGC54S				0.449	0.047	0.252				
SMGC55S	4.0	4.2	4.3	0.508	0.126	0.311	7.15	1.30	1650	2100
SMGC56S	5/32	.166	.170	0.571	0.189	0.374	.281	.051	370	470
SMGC58S				0.697	0.311	0.500				
SMGC64S				0.469	0.047	0.252				
SMGC66S				0.591	0.126	0.374				
SMGC68S	4.8	5.0	5.1	0.717	0.252	0.500	8.85	1.55	2400	3030
SMGC610S	3/16	.197	.201	0.843	0.374	0.626	.348	.061	540	680
SMGC612S				0.969	0.500	0.752				



**STEEL BODY  
STEEL MANDREL**

**ISO 9001 Certified  
Made according to IFI Specifications**

Material  
Body Low Carbon Steel  
Mandrel Carbon Steel

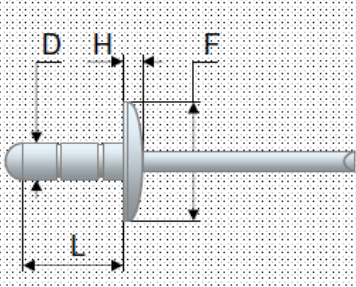

Finishes  
Body Zinc Plating  
Mandrel Zinc Plating

**Recommended Drill/Hole  
Size**

1/8" dia. rivet #30  
5/32" dia. rivet #20  
3/16" dia. rivet #11  
1/4" dia. rivet F

Rivet Code	D mm inch nom	Hole Dia		L inch	Grip Range		F mm inch nom	H mm inch max	Typical Ultimate Strength	
		mm	inch		min.	max.			Shear N lbs	Tensile N lbs
		min	max							
SMGL43S				0.366	0.020	0.189				
SMGL44S	3.2	3.4	3.5	0.429	0.063	0.252	9.50	1.65	1160	1380
SMGL45S	1/8	.134	.138	0.488	0.126	0.311	.375	.065	260	310
SMGL47S				0.614	0.252	0.437				
SMGL54S				0.449	0.047	0.252				
SMGL55S	4.0	4.2	4.3	0.508	0.126	0.311	11.90	1.90	1650	2100
SMGL56S	5/32	.166	.170	0.571	0.189	0.374	.468	.075	370	470
SMGL58S				0.697	0.311	0.500				
SMGL64S				0.469	0.047	0.252				
SMGL66S	4.8	5.0	5.1	0.591	0.126	0.374	13.90	2.15	2400	3030
SMGL68S	3/16	.197	.201	0.717	0.252	0.500	.547	.085	540	680
SMGL610S				0.843	0.374	0.626				
SMGL612S				0.969	0.500	0.752				
SMGXL64S				0.469	0.047	0.252				
SMGXL66S	4.8	5.0	5.1	0.591	0.126	0.374	15.90	2.35	2400	3030
SMGXL68S	3/16	.197	.201	0.717	0.252	0.500	.625	.092	540	680
SMGXL610S				0.843	0.374	0.626				
SMGXL612S				0.969	0.500	0.752				

**STAINLESS STEEL BODY  
STAINLESS STEEL MANDREL**

**ISO 9001 Certified  
Made according to IFI Specifications**

Material  
Body 300 Series  
Stainless Steel  
Mandrel 300 Series  
Stainless Steel

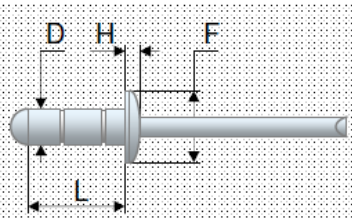

Finishes  
Body Polished  
Mandrel Polished

Rivet Code	D mm inch nom	Hole Dia mm inch		L inch	Grip Range inch		F mm inch nom	H mm inch max	Typical Ultimate Strength	
		min	max		min.	max.			Shear N lbs	Tensile N lbs
SSMG43SS	3.2 1/8	3.4 .134	3.5 .138	0.366	0.020	0.189	6.35 .250	1.05 .041	1870 420	2090 470
SSMG44SS				0.429	0.063	0.252				
SSMG45SS				0.488	0.126	0.311				
SSMG47SS				0.614	0.252	0.437				
SSMG54SS	4.0 5/32	4.2 .166	4.3 .170	0.449	0.047	0.252	7.95 .312	1.30 .051	2900 650	3600 810
SSMG55SS				0.508	0.126	0.311				
SSMG56SS				0.571	0.189	0.374				
SSMG58SS				0.697	0.311	0.500				
SSMG64SS	4.8 3/16	5.0 .197	5.1 .201	0.469	0.047	0.252	9.50 .375	1.55 .061	4230 950	4670 1050
SSMG66SS				0.591	0.126	0.374				
SSMG68SS				0.717	0.252	0.500				
SSMG610SS				0.843	0.374	0.626				
SSMG612SS				0.969	0.500	0.752				

**Recommended Drill/Hole Size**

1/8" dia. rivet #30  
5/32" dia. rivet #20  
3/16" dia. rivet #11  
1/4" dia. rivet F

**STAINLESS STEEL BODY  
STAINLESS STEEL MANDREL**

**120° Countersunk Head**

Material  
Body 300 Series  
Stainless Steel  
Mandrel 300 Series  
Stainless Steel

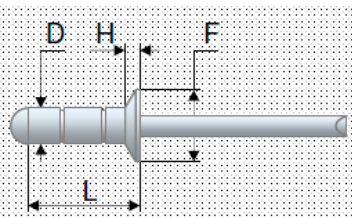

Finishes  
Body Polished  
Mandrel Polished

Rivet Code	D mm inch nom	Hole Dia mm inch		L inch	Grip Range inch		F mm inch nom	H mm inch max	Typical Ultimate Strength	
		min	max		min.	max.			Shear N lbs	Tensile N lbs
SSMGC44SS	3.2 1/8	3.4 .134	3.5 .138	0.429	0.063	0.252	5.60 .220	1.05 .041	1870 420	2090 470
SSMGC45SS				0.488	0.126	0.311				
SSMGC47SS				0.614	0.252	0.437				
SSMGC54SS	4.0 5/32	4.2 .166	4.3 .170	0.449	0.047	0.252	7.15 .281	1.30 .051	2900 650	3600 810
SSMGC55SS				0.508	0.126	0.311				
SSMGC56SS				0.571	0.189	0.374				
SSMGC58SS				0.697	0.311	0.500				
SSMGC64SS	4.8 3/16	5.0 .197	5.1 .201	0.469	0.047	0.252	8.85 .348	1.55 .061	4230 950	4670 1050
SSMGC66SS				0.591	0.126	0.374				
SSMGC68SS				0.717	0.252	0.500				
SSMGC610SS				0.843	0.374	0.626				
SSMGC612SS				0.969	0.500	0.752				

**ALUMINUM BODY  
ALUMINIUM MANDREL**

**ISO 9001 Certified  
Made according to IFI Specifications**

Material  
Body 1100 (Al99Cu)  
Mandrel 7000 Series  
Aluminum Alloy

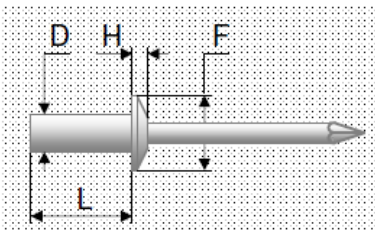

Finishes  
Body Polished  
Mandrel Polished

**Recommended Drill/Hole  
Size**

1/8" dia. rivet #30  
5/32" dia. rivet #20  
3/16" dia. rivet #11  
1/4" dia. rivet F

Rivet Code	D mm inch nom	Hole Dia		L inch	Grip Range		F mm inch nom	H mm inch max	Typical Ultimate Strength	
		mm	inch		min.	max.			Shear N lbs	Tensile N lbs
		min	max							
AS41A	3.2 1/8	3.3 .129	3.4 .133	0.295	0.031	0.063	6.00 .236	1.30 .051	445 100	490 110
AS42A				0.358	0.063	0.126				
AS43A				0.421	0.126	0.189				
AS44A				0.484	0.189	0.252				
AS45A				0.547	0.252	0.312				
AS46A				0.610	0.312	0.375				
AS48A				0.736	0.375	0.500				
AS52A	4.0 5/32	4.1 .160	4.2 .164	0.374	0.063	0.126	7.90 .312	1.70 .067	580 130	710 160
AS53A				0.437	0.126	0.189				
AS54A				0.500	0.189	0.252				
AS55A				0.563	0.252	0.312				
AS56A				0.626	0.312	0.375				
AS58A				0.752	0.375	0.500				
AS62A	4.8 3/16	4.9 .192	5.0 .196	0.406	0.063	0.126	9.50 .375	2.05 .081	940 210	1100 250
AS63A				0.469	0.126	0.187				
AS64A				0.531	0.188	0.250				
AS66A				0.654	0.250	0.375				
AS68A				0.780	0.375	0.500				
AS610A				0.906	0.500	0.626				
AS612A				1.031	0.626	0.752				

**ALUMINUM BODY  
ALUMINIUM MANDREL**

**ISO 9001 Certified  
Made according to IFI Specifications**

Material  
Body 1100 (Al99Cu)  
Mandrel 7000 Series  
Aluminum Alloy

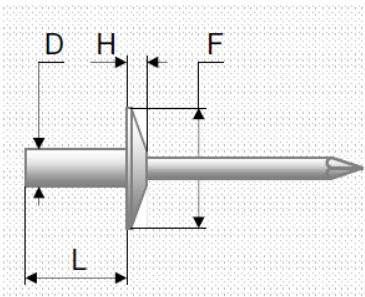

Finishes  
Body Polished  
Mandrel Polished

Recommended Drill/Hole Size		
1/8"	dia. rivet	#30
5/32"	dia. rivet	#20
3/16"	dia. rivet	#11
1/4"	dia. rivet	F

Rivet Code	D mm inch nom	Hole Dia mm inch		L inch	Grip Range inch		F mm inch nom	H mm inch max	Typical Ultimate Strength	
		min	max		min.	max.			Shear N lbs	Tensile N lbs
ASL41A				0.295	0.031	0.063				
ASL42A				0.358	0.063	0.126				
ASL43A	3.2	3.3	3.4	0.421	0.126	0.189	9.50	2.05	445	490
ASL44A	1/8	.129	.133	0.484	0.189	0.252	.375	.081	100	110
ASL45A				0.547	0.252	0.312				
ASL46A				0.610	0.312	0.375				
ASL48A				0.736	0.375	0.500				
ASL52A				0.374	0.063	0.126				
ASL53A				0.437	0.126	0.189				
ASL54A	4.0	4.1	4.2	0.500	0.189	0.252	11.90	2.40	580	710
ASL55A	5/32	.160	.164	0.563	0.252	0.312	.468	.094	130	160
ASL56A				0.626	0.312	0.375				
ASL58A				0.752	0.375	0.500				
ASL62A				0.406	0.063	0.126				
ASL63A				0.469	0.126	0.187				
ASL64A	4.8	4.9	5.0	0.531	0.188	0.250	13.90	2.60	940	1100
ASL66A	3/16	.192	.196	0.654	0.250	0.375	.547	.102	210	250
ASL68A				0.780	0.375	0.500				
ASL610A				0.906	0.500	0.626				
ASL612A				1.031	0.626	0.752				
AXL62A				0.406	0.063	0.126				
AXL63A				0.469	0.126	0.187				
AXL64A	4.8	4.9	5.0	0.531	0.188	0.250	15.90	2.80	940	1100
AXL66A	3/16	.192	.196	0.654	0.250	0.375	.625	.110	210	250
AXL68A				0.780	0.375	0.500				
AXL610A				0.906	0.500	0.626				
AXL612A				1.031	0.626	0.752				



# GPF SYSTEMS

# CLOSED-END SEALED BLIND RIVET HOLLOW CORE

## ALUMINUM BODY ALUMINIUM MANDREL

ISO 9001 Certified  
Made according to IFI Specifications

Material  
Body 1100 (Al99Cu)  
Mandrel 7000 Series  
Aluminum Alloy

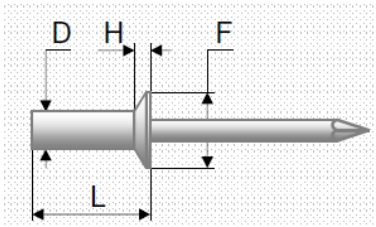

Finishes  
Body Polished  
Mandrel Polished

Recommended Drill/Hole Size		
1/8"	dia. rivet	#30
5/32"	dia. rivet	#20
3/16"	dia. rivet	#11
1/4"	dia. rivet	F

Rivet Code	D mm inch nom	Hole Dia mm inch		L inch	Grip Range inch		F mm inch nom	H mm inch max	Typical Ultimate Strength	
		min	max		min.	max.			Shear N lbs	Tensile N lbs
ASC42A				0.394	0.063	0.126				
ASC43A				0.457	0.126	0.189				
ASC44A	3.2	3.3	3.4	0.520	0.189	0.252	6.00	1.30	445	490
ASC45A	1/8	.129	.133	0.583	0.252	0.312	.236	.051	100	110
ASC46A				0.646	0.312	0.375				
ASC48A				0.772	0.375	0.500				
ASC52A				0.425	0.063	0.126				
ASC53A				0.488	0.126	0.189				
ASC54A	4.0	4.1	4.2	0.551	0.189	0.252	7.95	1.65	580	710
ASC55A	5/32	.160	.164	0.610	0.252	0.312	.312	.065	130	160
ASC56A				0.673	0.312	0.375				
ASC58A				0.799	0.375	0.500				
ASC62A				0.472	0.063	0.126				
ASC63A				0.535	0.126	0.189				
ASC64A	4.8	4.9	5.0	0.602	0.188	0.250	9.50	1.90	940	1100
ASC66A	3/16	.192	.196	0.736	0.250	0.375	.375	.075	210	250
ASC68A				0.850	0.375	0.500				
ASC610A				1.024	0.500	0.626				
ASC612A				1.102	0.626	0.752				



# GPF SYSTEMS

# CLOSED-END SEALED BLIND RIVET HOLLOW CORE

## ALUMINUM BODY STEEL MANDREL

ISO 9001 Certified  
Made according to IFI Specifications

Material  
Body 5056 (AlMg5)  
Mandrel Carbon Steel

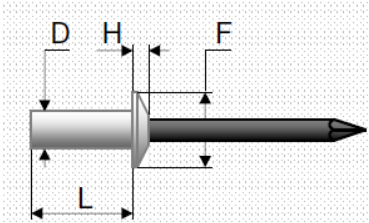

Finishes  
Body Polished  
Mandrel Phosphated

Recommended Drill/Hole Size		
1/8" dia. rivet	#30	
5/32" dia. rivet	#20	
3/16" dia. rivet	#11	
1/4" dia. rivet	F	

Rivet Code	D mm inch nom	Hole Dia		L inch	Grip Range inch		F mm inch nom	H mm inch max	Typical Ultimate Strength	
		mm	inch		min.	max.			Shear	Tensile
		min	max		N lbs	N lbs				
AS41S				0.295	0.031	0.063				
AS42S				0.358	0.063	0.126				
AS43S	3.2	3.3	3.4	0.421	0.126	0.189	6.00	1.30	1070	1250
AS44S	1/8	.129	.133	0.484	0.189	0.252	.236	.051	240	280
AS45S				0.547	0.252	0.312				
AS46S				0.610	0.312	0.375				
AS48S				0.736	0.375	0.500				
AS52S				0.374	0.063	0.126				
AS53S				0.437	0.126	0.189				
AS54S	4.0	4.1	4.2	0.500	0.189	0.252	7.90	1.70	1560	2140
AS55S	5/32	.160	.164	0.563	0.252	0.312	.312	.067	350	480
AS56S				0.626	0.312	0.375				
AS58S				0.752	0.375	0.500				
AS62S				0.406	0.063	0.126				
AS63S				0.469	0.126	0.187				
AS64S	4.8	4.9	5.0	0.531	0.188	0.250	9.50	2.05	2230	3070
AS66S	3/16	.192	.196	0.654	0.250	0.375	.375	.081	500	690
AS68S				0.780	0.375	0.500				
AS610S				0.906	0.500	0.626				
AS612S				1.031	0.626	0.752				
AS82S				0.445	0.063	0.126				
AS84S				0.571	0.126	0.250				
AS86S				0.693	0.250	0.375				
AS88S	6.4	6.5	6.6	0.819	0.375	0.500	12.70	2.50	4000	4890
AS810S	1/4	.257	.261	0.945	0.500	0.626	.500	.098	900	1100
AS812S				1.071	0.626	0.752				
AS814S				1.193	0.752	0.875				
AS816S				1.319	0.875	1.000				

**ALUMINUM BODY  
STEEL MANDREL**

**ISO 9001 Certified  
Made according to IFI Specifications**

Material  
Body 5056 (AlMg5)  
Mandrel Carbon Steel

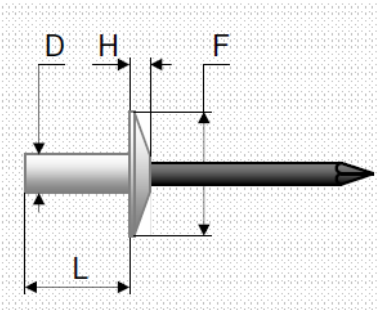

Finishes  
Body Polished  
Mandrel Phosphorated

Recommended Drill/Hole Size	
1/8" dia. rivet	#30
5/32" dia. rivet	#20
3/16" dia. rivet	#11
1/4" dia. rivet	F

Rivet Code	D mm inch nom	Hole Dia mm inch		L inch	Grip Range inch		F mm inch nom	H mm inch max	Typical Ultimate Strength	
		min	max		min.	max.			Shear N lbs	Tensile N lbs
ASL41S				0.295	0.031	0.063				
ASL42S				0.358	0.063	0.126				
ASL43S	3.2	3.3	3.4	0.421	0.126	0.189	9.50	2.05	1070	1250
ASL44S	1/8	.129	.133	0.484	0.189	0.252	.375	.081	240	280
ASL45S				0.547	0.252	0.312				
ASL46S				0.610	0.312	0.375				
ASL48S				0.736	0.375	0.500				
ASL52S				0.374	0.063	0.126				
ASL53S				0.437	0.126	0.189				
ASL54S	4.0	4.1	4.2	0.500	0.189	0.252	11.90	2.40	1560	2140
ASL55S	5/32	.160	.164	0.563	0.252	0.312	.468	.094	350	480
ASL56S				0.626	0.312	0.375				
ASL58S				0.752	0.375	0.500				
ASL62S				0.406	0.063	0.126				
ASL63S				0.469	0.126	0.187				
ASL64S	4.8	4.9	5.0	0.531	0.188	0.250	13.90	2.60	2230	3070
ASL66S	3/16	.192	.196	0.654	0.250	0.375	.547	.102	500	690
ASL68S				0.780	0.375	0.500				
ASL610S				0.906	0.500	0.626				
ASL612S				1.031	0.626	0.752				
AXL62S				0.406	0.063	0.126				
AXL63S				0.469	0.126	0.187				
AXL64S	4.8	4.9	5.0	0.531	0.188	0.250	15.90	2.80	2230	3070
AXL66S	3/16	.192	.196	0.654	0.250	0.375	.625	.110	500	690
AXL68S				0.780	0.375	0.500				
AXL610S				0.906	0.500	0.626				
AXL612S				1.031	0.626	0.752				

**ALUMINUM BODY  
STEEL MANDREL**

**ISO 9001 Certified  
Made according to IFI Specifications**

Material  
Body 5056 (AlMg5)  
Mandrel Carbon Steel

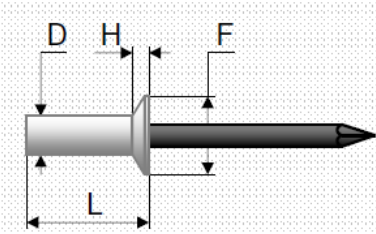

Finishes  
Body Polished  
Mandrel Phosphated

**Recommended Drill/Hole  
Size**

1/8" dia. rivet #30  
5/32" dia. rivet #20  
3/16" dia. rivet #11  
1/4" dia. rivet F

Rivet Code	D mm inch nom	Hole Dia mm inch		L inch	Grip Range inch		F mm inch nom	H mm inch max	Typical Ultimate Strength	
		min	max		min.	max.			Shear N lbs	Tensile N lbs
ASC42S				0.394	0.063	0.126				
ASC43S				0.457	0.126	0.189				
ASC44S	3.2	3.3	3.4	0.520	0.189	0.252	6.00	1.30	1070	1250
ASC45S	1/8	.129	.133	0.583	0.252	0.312	.236	.051	240	280
ASC46S				0.646	0.312	0.375				
ASC48S				0.772	0.375	0.500				
ASC52S				0.425	0.063	0.126				
ASC53S				0.488	0.126	0.189				
ASC54S	4.0	4.1	4.2	0.551	0.189	0.252	7.95	1.65	1560	2140
ASC55S	5/32	.160	.164	0.610	0.252	0.312	.312	.065	350	480
ASC56S				0.673	0.312	0.375				
ASC58S				0.799	0.375	0.500				
ASC62S				0.472	0.063	0.126				
ASC63S				0.535	0.126	0.189				
ASC64S				0.602	0.188	0.250				
ASC66S	4.8	4.9	5.0	0.736	0.250	0.375	9.50	1.90	2230	3070
ASC68S	3/16	.192	.196	0.850	0.375	0.500	.375	.075	500	690
ASC610S				1.024	0.500	0.626				
ASC612S				1.102	0.626	0.752				

# GPF SYSTEMS

# CLOSED-END SEALED BLIND RIVET HOLLOW CORE

## ALUMINUM BODY STAINLESS STEEL MANDREL

ISO 9001 Certified  
Made according to IFI Specifications

Material  
Body 5056 (AlMg5)  
Mandrel 300 Series  
Stainless Steel

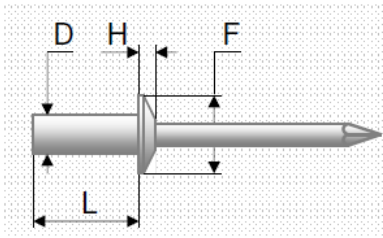

Finishes  
Body Polished  
Mandrel Polished

### Recommended Drill/Hole Size

1/8" dia. rivet	#30
5/32" dia. rivet	#20
3/16" dia. rivet	#11
1/4" dia. rivet	F

Rivet Code	D mm inch nom	Hole Dia mm inch		L inch	Grip Range inch		F mm inch nom	H mm inch max	Typical Ultimate Strength	
		min	max		min.	max.			Shear N lbs	Tensile N lbs
AS41SS	3.2 1/8	3.3 .129	3.4 .133	0.295	0.031	0.063	6.00 .236	1.30 .051	1070 240	1250 280
AS42SS				0.358	0.063	0.126				
AS43SS				0.421	0.126	0.189				
AS44SS				0.484	0.189	0.252				
AS45SS				0.547	0.252	0.312				
AS46SS				0.610	0.312	0.375				
AS48SS				0.736	0.375	0.500				
AS52SS	4.0 5/32	4.1 .160	4.2 .164	0.374	0.063	0.126	7.90 .312	1.70 .067	1560 350	2140 480
AS53SS				0.437	0.126	0.189				
AS54SS				0.500	0.189	0.252				
AS55SS				0.563	0.252	0.312				
AS56SS				0.626	0.312	0.375				
AS58SS				0.752	0.375	0.500				
AS62SS	4.8 3/16	4.9 .192	5.0 .196	0.406	0.063	0.126	9.50 .375	2.05 .081	2230 500	3070 690
AS63SS				0.469	0.126	0.187				
AS64SS				0.531	0.188	0.250				
AS66SS				0.654	0.250	0.375				
AS68SS				0.780	0.375	0.500				
AS610SS				0.906	0.500	0.626				
AS612SS				1.031	0.626	0.752				
AS82SS				6.4 1/4	6.5 .257	6.6 .261				
AS84SS	0.571	0.126	0.250							
AS86SS	0.693	0.250	0.375							
AS88SS	0.819	0.375	0.500							
AS810SS	0.945	0.500	0.626							
AS812SS	1.071	0.626	0.752							
AS814SS	1.193	0.752	0.875							
AS816SS	1.319	0.875	1.000							



**ALUMINUM BODY  
STAINLESS STEEL MANDREL**

**ISO 9001 Certified  
Made according to IFI Specifications**

Material  
Body 5056 (AlMg5)  
Mandrel 300 Series  
Stainless Steel

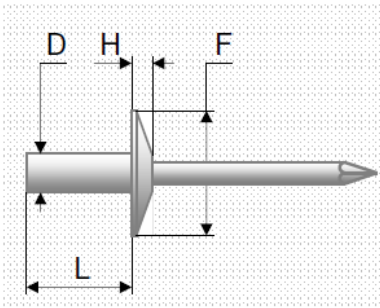

Finishes  
Body Polished  
Mandrel Polished

Recommended Drill/Hole Size		
1/8" dia. rivet	#30	
5/32" dia. rivet	#20	
3/16" dia. rivet	#11	
1/4" dia. rivet	F	

Rivet Code	D		Hole Dia		L	Grip Range		F	H	Typical Ultimate Strength	
	mm	inch	mm	inch		inch	inch			mm	inch
	nom		min	max	min.	max.	nom	max	N lbs	N lbs	
ASL41SS					0.295	0.031	0.063				
ASL42SS					0.358	0.063	0.126				
ASL43SS					0.421	0.126	0.189				
ASL44SS	3.2	1/8	3.3	.129	0.484	0.189	0.252	9.50	2.05	1070	1250
ASL45SS					0.547	0.252	0.312	.375	.081	240	280
ASL46SS					0.610	0.312	0.375				
ASL48SS					0.736	0.375	0.500				
ASL52SS					0.374	0.063	0.126				
ASL53SS					0.437	0.126	0.189				
ASL54SS	4.0		4.1		0.500	0.189	0.252	11.90	2.40	1560	2140
ASL55SS	5/32		.160		0.563	0.252	0.312	.468	.094	350	480
ASL56SS					0.626	0.312	0.375				
ASL58SS					0.752	0.375	0.500				
ASL62SS					0.406	0.063	0.126				
ASL63SS					0.469	0.126	0.187				
ASL64SS					0.531	0.188	0.250				
ASL66SS	4.8		4.9		0.654	0.250	0.375	13.90	2.60	2230	3070
ASL68SS	3/16		.192		0.780	0.375	0.500	.547	.102	500	690
ASL610SS					0.906	0.500	0.626				
ASL612SS					1.031	0.626	0.752				
AXL62SS					0.406	0.063	0.126				
AXL63SS					0.469	0.126	0.187				
AXL64SS					0.531	0.188	0.250				
AXL66SS	4.8		4.9		0.654	0.250	0.375	15.90	2.80	2230	3070
AXL68SS	3/16		.192		0.780	0.375	0.500	.625	.110	500	690
AXL610SS					0.906	0.500	0.626				
AXL612SS					1.031	0.626	0.752				



**ALUMINUM BODY  
STAINLESS STEEL MANDREL**

**ISO 9001 Certified  
Made according to IFI Specifications**

Material  
Body 5056 (AlMg5)  
Mandrel 300 Series  
Stainless Steel

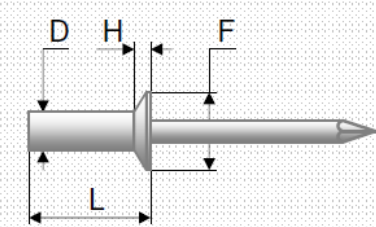

Finishes  
Body Polished  
Mandrel Polished

Rivet Code	D mm inch nom	Hole Dia mm inch		L inch	Grip Range inch		F mm inch nom	H mm inch max	Typical Ultimate Strength	
		min	max		min.	max.			Shear N lbs	Tensile N lbs
ASC42SS				0.394	0.063	0.126				
ASC43SS				0.457	0.126	0.189				
ASC44SS	3.2	3.3	3.4	0.520	0.189	0.252	6.00	1.30	1070	1250
ASC45SS	1/8	.129	.133	0.583	0.252	0.312	.236	.051	240	280
ASC46SS				0.646	0.312	0.375				
ASC48SS				0.772	0.375	0.500				
ASC52SS				0.425	0.063	0.126				
ASC53SS				0.488	0.126	0.189				
ASC54SS	4.0	4.1	4.2	0.551	0.189	0.252	7.95	1.65	1560	2140
ASC55SS	5/32	.160	.164	0.610	0.252	0.312	.312	.065	350	480
ASC56SS				0.673	0.312	0.375				
ASC58SS				0.799	0.375	0.500				
ASC62SS				0.472	0.063	0.126				
ASC63SS				0.535	0.126	0.189				
ASC64SS	4.8	4.9	5.0	0.602	0.188	0.250	9.50	1.90	2230	3070
ASC66SS	3/16	.192	.196	0.736	0.250	0.375	.375	.075	500	690
ASC68SS				0.850	0.375	0.500				
ASC610SS				1.024	0.500	0.626				
ASC612SS				1.102	0.626	0.752				

Recommended Drill/Hole Size		
1/8" dia. rivet	#30	
5/32" dia. rivet	#20	
3/16" dia. rivet	#11	
1/4" dia. rivet	F	

# GPF SYSTEMS

# CLOSED-END SEALED BLIND RIVET HOLLOW CORE

## STEEL BODY STEEL MANDREL

ISO 9001 Certified  
Made according to IFI Specifications

Material  
Body Low Carbon Steel  
Mandrel Carbon Steel

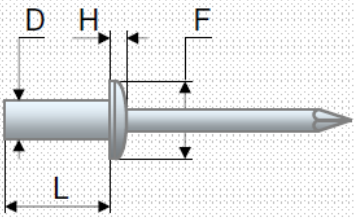

Finishes  
Body Zinc Plating  
Mandrel Zinc Plating

### Recommended Drill/Hole Size

1/8" dia. rivet #30  
5/32" dia. rivet #20  
3/16" dia. rivet #11  
1/4" dia. rivet F

Rivet Code	D mm inch nom	Hole Dia mm inch		L inch	Grip Range inch		F mm inch nom	H mm inch max	Typical Ultimate Strength	
		min	max		min.	max.			Shear N lbs	Tensile N lbs
SS41SCE	3.2 1/8	3.3 .129	3.4 .133	0.295	0.031	0.063	6.00 .236	1.30 .051	1150 258	1300 292
SS42SCE				0.358	0.063	0.126				
SS43SCE				0.421	0.126	0.189				
SS44SCE				0.484	0.189	0.252				
SS45SCE				0.547	0.252	0.312				
SS46SCE				0.610	0.312	0.375				
SS48SCE				0.736	0.375	0.500				
SS52SCE	4.0 5/32	4.1 .160	4.2 .164	0.374	0.063	0.126	7.90 .312	1.70 .067	1700 380	1860 418
SS53SCE				0.437	0.126	0.189				
SS54SCE				0.500	0.189	0.252				
SS55SCE				0.563	0.252	0.312				
SS56SCE				0.626	0.312	0.375				
SS58SCE				0.752	0.375	0.500				
SS62SCE	4.8 3/16	4.9 .192	5.0 .196	0.406	0.063	0.126	9.50 .375	2.05 .081	2400 540	2800 630
SS63SCE				0.469	0.126	0.187				
SS64SCE				0.531	0.188	0.250				
SS66SCE				0.654	0.250	0.375				
SS68SCE				0.780	0.375	0.500				
SS610SCE				0.906	0.500	0.626				
SS612SCE				1.031	0.626	0.752				
SS82SCE	6.4 1/4	6.5 .257	6.6 .261	0.445	0.063	0.126	12.70 .500	2.50 .098	3600 810	4000 900
SS84SCE				0.571	0.126	0.250				
SS86SCE				0.693	0.250	0.375				
SS88SCE				0.819	0.375	0.500				
SS810SCE				0.945	0.500	0.626				
SS812SCE				1.071	0.626	0.752				
SS814SCE				1.193	0.752	0.875				
SS816SCE				1.319	0.875	1.000				

**STEEL BODY  
STEEL MANDREL**

**ISO 9001 Certified  
Made according to IFI Specifications**

Material  
Body Low Carbon Steel  
Mandrel Carbon Steel

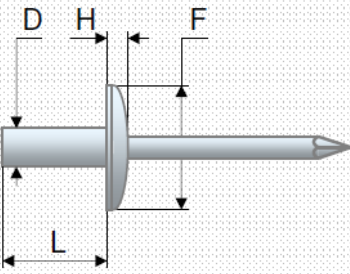

Body Zinc Plating  
Mandrel Zinc Plating

**Recommended Drill/Hole  
Size**

- 1/8" dia. rivet #30
- 5/32" dia. rivet #20
- 3/16" dia. rivet #11
- 1/4" dia. rivet F

Rivet Code	D mm inch nom	Hole Dia mm inch		L inch	Grip Range inch		F mm inch nom	H mm inch max	Typical Ultimate Strength	
		min	max		min.	max.			Shear N lbs	Tensile N lbs
SSL41SCE	3.2 1/8	3.3 .129	3.4 .133	0.295	0.031	0.063	6.00 .236	1.30 .051	1150 258	1300 292
SSL42SCE				0.358	0.063	0.126				
SSL43SCE				0.421	0.126	0.189				
SSL44SCE				0.484	0.189	0.252				
SSL45SCE				0.547	0.252	0.312				
SSL46SCE				0.610	0.312	0.375				
SSL48SCE				0.736	0.375	0.500				
SSL52SCE	4.0 5/32	4.1 .160	4.2 .164	0.374	0.063	0.126	7.90 .312	1.70 .067	1700 380	1860 418
SSL53SCE				0.437	0.126	0.189				
SSL54SCE				0.500	0.189	0.252				
SSL55SCE				0.563	0.252	0.312				
SSL56SCE				0.626	0.312	0.375				
SSL58SCE				0.752	0.375	0.500				
SSL62SCE	4.8 3/16	4.9 .192	5.0 .196	0.406	0.063	0.126	13.90 .547	2.05 .081	2400 540	2800 630
SSL63SCE				0.469	0.126	0.187				
SSL64SCE				0.531	0.188	0.250				
SSL66SCE				0.654	0.250	0.375				
SSL68SCE				0.780	0.375	0.500				
SSL610SCE				0.906	0.500	0.626				
SSL612SCE				1.031	0.626	0.752				
SSXL62SCE	4.8 3/16	4.9 .192	5.0 .196	0.406	0.063	0.126	15.90 .625	2.05 .081	2400 540	2800 630
SSXL63SCE				0.469	0.126	0.187				
SSXL64SCE				0.531	0.188	0.250				
SSXL66SCE				0.654	0.250	0.375				
SSXL68SCE				0.780	0.375	0.500				
SSXL610SCE				0.906	0.500	0.626				
SSXL612SCE				1.031	0.626	0.752				

# GPF SYSTEMS

# CLOSED-END SEALED BLIND RIVET HOLLOW CORE

## STAINLESS STEEL BODY STAINLESS STEEL MANDREL

ISO 9001 Certified  
Made according to IFI Specifications

Material  
Body 300 series  
Stainless Steel  
Mandrel 400 series  
Stainless Steel

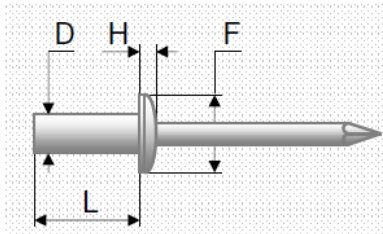

Finishes  
Body Polished  
Mandrel Polished

### Recommended Drill/Hole Size

1/8" dia. rivet #30  
5/32" dia. rivet #20  
3/16" dia. rivet #11  
1/4" dia. rivet F

Rivet Code	D mm inch nom	Hole Dia mm inch		L inch	Grip Range inch		F mm inch nom	H mm inch max	Typical Ultimate Strength	
		min	max		min.	max.			Shear N lbs	Tensile N lbs
SSS41SS				0.295	0.031	0.063				
SSS42SS				0.358	0.063	0.126				
SSS43SS	3.2	3.3	3.4	0.421	0.126	0.189	6.00	1.30	1780	2000
SSS44SS	1/8	.129	.133	0.484	0.189	0.252	.236	.051	400	450
SSS45SS				0.547	0.252	0.312				
SSS46SS				0.610	0.312	0.375				
SSS48SS				0.736	0.375	0.500				
SSS52SS				0.374	0.063	0.126				
SSS53SS				0.437	0.126	0.189				
SSS54SS	4.0	4.1	4.2	0.500	0.189	0.252	7.90	1.70	3120	3560
SSS55SS	5/32	.160	.164	0.563	0.252	0.312	.312	.067	700	800
SSS56SS				0.626	0.312	0.375				
SSS58SS				0.752	0.375	0.500				
SSS62SS				0.406	0.063	0.126				
SSS63SS				0.469	0.126	0.187				
SSS64SS	4.8	4.9	5.0	0.531	0.188	0.250	9.50	2.05	3790	4010
SSS66SS	3/16	.192	.196	0.654	0.250	0.375	.375	.081	850	900
SSS68SS				0.780	0.375	0.500				
SSS610SS				0.906	0.500	0.626				
SSS612SS				1.031	0.626	0.752				
SSS82SS				0.445	0.063	0.126				
SSS84SS				0.571	0.126	0.250				
SSS86SS				0.693	0.250	0.375				
SSS88SS	6.4	6.5	6.6	0.819	0.375	0.500	12.70	2.50	6000	8000
SSS810SS	1/4	.257	.261	0.945	0.500	0.626	.500	.098	1348	1797
SSS812SS				1.071	0.626	0.752				
SSS814SS				1.193	0.752	0.875				
SSS816SS				1.319	0.875	1.000				



**STAINLESS STEEL BODY  
STAINLESS STEEL MANDREL**

**ISO 9001 Certified  
Made according to IFI Specifications**

Material  
Body 300 series  
Stainless Steel  
Mandrel 400 series  
Stainless Steel

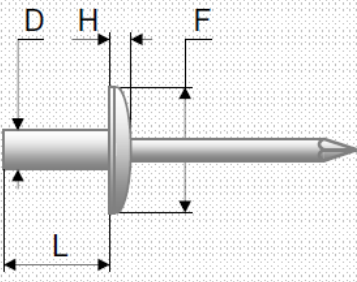

Finishes  
Body Polished  
Mandrel Polished

Rivet Code	D mm inch nom	Hole Dia mm inch		L inch	Grip Range inch		F mm inch nom	H mm inch max	Typical Ultimate Strength	
		min	max		min.	max.			Shear N lbs	Tensile N lbs
SSSL41SS				0.295	0.031	0.063				
SSSL42SS				0.358	0.063	0.126				
SSSL43SS	3.2	3.3	3.4	0.421	0.126	0.189	6.00	1.30	1780	2000
SSSL44SS	1/8	.129	.133	0.484	0.189	0.252	.236	.051	400	450
SSSL45SS				0.547	0.252	0.312				
SSSL46SS				0.610	0.312	0.375				
SSSL48SS				0.736	0.375	0.500				
SSSL52SS				0.374	0.063	0.126				
SSSL53SS				0.437	0.126	0.189				
SSSL54SS	4.0	4.1	4.2	0.500	0.189	0.252	7.90	1.70	3120	3560
SSSL55SS	5/32	.160	.164	0.563	0.252	0.312	.312	.067	700	800
SSSL56SS				0.626	0.312	0.375				
SSSL58SS				0.752	0.375	0.500				
SSSL62SS				0.406	0.063	0.126				
SSSL63SS				0.469	0.126	0.187				
SSSL64SS				0.531	0.188	0.250				
SSSL66SS	4.8	4.9	5.0	0.654	0.250	0.375	13.90	2.05	3790	4010
SSSL68SS	3/16	.192	.196	0.780	0.375	0.500	.547	.081	850	900
SSSL610SS				0.906	0.500	0.626				
SSSL612SS				1.031	0.626	0.752				
SSSXL62SS				0.406	0.063	0.126				
SSSXL63SS				0.469	0.126	0.187				
SSSXL64SS				0.531	0.188	0.250				
SSSXL66SS	4.8	4.9	5.0	0.654	0.250	0.375	15.90	2.05	3790	4010
SSSXL68SS	3/16	.192	.196	0.780	0.375	0.500	.625	.081	850	900
SSSXL610SS				0.906	0.500	0.626				
SSSXL612SS				1.031	0.626	0.752				

**Recommended Drill/Hole  
Size**

1/8" dia. rivet #30  
5/32" dia. rivet #20  
3/16" dia. rivet #11  
1/4" dia. rivet F

# GPF SYSTEMS

# CLOSED-END SEALED BLIND RIVET HOLLOW CORE

## COPPER BODY STEEL MANDREL

ISO 9001 Certified  
Made according to IFI Specifications

Material  
Body Copper  
Mandrel Carbon Steel

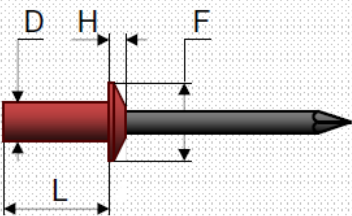

Finishes  
Body Polished  
Mandrel Phosphorated

### Recommended Drill/Hole Size

1/8" dia. rivet	#30
5/32" dia. rivet	#20
3/16" dia. rivet	#11
1/4" dia. rivet	F

Rivet Code	D mm inch nom	Hole Dia mm inch		L inch	Grip Range inch		F mm inch nom	H mm inch max	Typical Ultimate Strength	
		min	max		min.	max.			Shear N lbs	Tensile N lbs
CS41S				0.295	0.031	0.063				
CS42S				0.358	0.063	0.126				
CS43S	3.2	3.3	3.4	0.421	0.126	0.189	6.00	1.30	980	1340
CS44S	1/8	.129	.133	0.484	0.189	0.252	.236	.051	220	300
CS45S				0.547	0.252	0.312				
CS46S				0.610	0.312	0.375				
CS48S				0.736	0.375	0.500				
CS52S				0.374	0.063	0.126				
CS53S				0.437	0.126	0.189				
CS54S	4.0	4.1	4.2	0.500	0.189	0.252	7.90	1.70	1350	2000
CS55S	5/32	.160	.164	0.563	0.252	0.312	.312	.067	305	450
CS56S				0.626	0.312	0.375				
CS58S				0.752	0.375	0.500				
CS62S				0.406	0.063	0.126				
CS63S				0.469	0.126	0.187				
CS64S				0.531	0.188	0.250				
CS66S	4.8	4.9	5.0	0.654	0.250	0.375	9.50	2.05	1950	2800
CS68S	3/16	.192	.196	0.780	0.375	0.500	.375	.081	438	630
CS610S				0.906	0.500	0.626				
CS612S				1.031	0.626	0.752				

**COPPER BODY  
STAINLESS STEEL MANDREL**

**ISO 9001 Certified  
Made according to IFI Specifications**

Material  
Body Copper  
Mandrel 300 Series

Stainless Steel

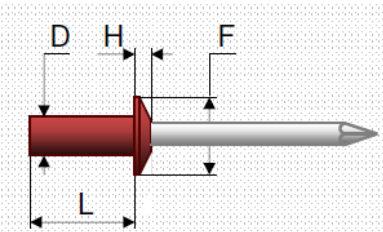

Finishes  
Body Polished  
Mandrel Polished

Recommended Drill/Hole Size		
1/8" dia. rivet	#30	
5/32" dia. rivet	#20	
3/16" dia. rivet	#11	
1/4" dia. rivet	F	

Rivet Code	D mm inch nom	Hole Dia mm inch		L inch	Grip Range inch		F mm inch nom	H mm inch max	Typical Ultimate Strength	
		min	max		min.	max.			Shear N lbs	Tensile N lbs
CS41SS				0.295	0.031	0.063				
CS42SS				0.358	0.063	0.126				
CS43SS	3.2	3.3	3.4	0.421	0.126	0.189	6.00	1.30	980	1340
CS44SS	1/8	.129	.133	0.484	0.189	0.252	.236	.051	220	300
CS45SS				0.547	0.252	0.312				
CS46SS				0.610	0.312	0.375				
CS48SS				0.736	0.375	0.500				
CS52SS				0.374	0.063	0.126				
CS53SS				0.437	0.126	0.189				
CS54SS	4.0	4.1	4.2	0.500	0.189	0.252	7.90	1.70	1350	2000
CS55SS	5/32	.160	.164	0.563	0.252	0.312	.312	.067	305	450
CS56SS				0.626	0.312	0.375				
CS58SS				0.752	0.375	0.500				
CS62SS				0.406	0.063	0.126				
CS63SS				0.469	0.126	0.187				
CS64SS	4.8	4.9	5.0	0.531	0.188	0.250	9.50	2.05	1950	2800
CS66SS	3/16	.192	.196	0.654	0.250	0.375	.375	.081	438	630
CS68SS				0.780	0.375	0.500				
CS610SS				0.906	0.500	0.626				
CS612SS				1.031	0.626	0.752				

**ALUMINIUM BODY  
STEEL MANDREL**

**ISO 9001 Certified  
Made according to IFI Specifications**

Material  
Body 5056 (AlMg5)  
Mandrel Carbon Steel

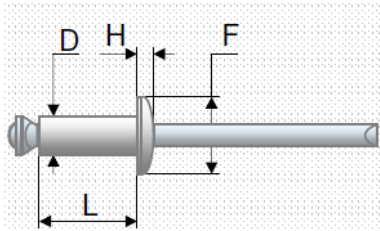

Finishes  
Body Polished  
Mandrel Zinc Plating

Recommended Drill/Hole Size		
1/8" dia. rivet	#30	
5/32" dia. rivet	#20	
3/16" dia. rivet	#11	
1/4" dia. rivet	F	

Rivet Code	D mm inch nom	Hole Dia mm inch		L inch	Grip Range inch		F mm inch nom	H mm inch max	Typical Ultimate Strength	
		min	max		min.	max.			Shear N lbs	Tensile N lbs
AT42S				0.358	0.063	0.126				
AT43S				0.421	0.126	0.189				
AT44S	3.2	3.4	3.5	0.484	0.189	0.252	6.35	1.05	800	720
AT45S	1/8	.134	.138	0.543	0.252	0.312	.250	.041	180	160
AT46S				0.606	0.312	0.375				
AT47S				0.669	0.375	0.437				
AT52S				0.378	0.063	0.126				
AT53S				0.441	0.126	0.189				
AT54S				0.504	0.189	0.252				
AT55S	4.0	4.2	4.3	0.563	0.252	0.312	7.95	1.30	1270	1160
AT56S	5/32	.166	.170	0.626	0.312	0.375	.312	.051	285	260
AT57S				0.689	0.375	0.437				
AT58S				0.752	0.437	0.500				
AT59S				0.815	0.500	0.563				
AT62S				0.398	0.063	0.126				
AT63S				0.461	0.126	0.189				
AT64S				0.524	0.189	0.252				
AT65S				0.583	0.252	0.312				
AT66S	4.8	5.0	5.1	0.646	0.312	0.375	9.50	1.55	1870	1610
AT67S	3/16	.197	.201	0.709	0.375	0.437	.375	.061	420	360
AT68S				0.772	0.437	0.500				
AT69S				0.835	0.500	0.563				
AT610S				0.898	0.563	0.625				
AT611S				0.961	0.625	0.688				
AT612S				1.024	0.688	0.752				



**ALUMINIUM BODY  
STEEL MANDREL**

**ISO 9001 Certified  
Made according to IFI Specifications**

Material  
Body 5056 (AlMg5)  
Mandrel Carbon Steel

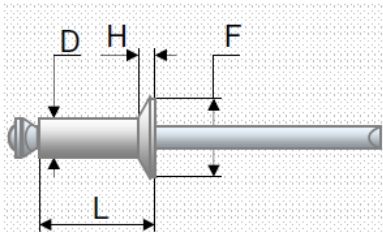

Finishes  
Body Polished  
Mandrel Zinc Plating

Recommended Drill/Hole Size		
1/8" dia. rivet	#30	
5/32" dia. rivet	#20	
3/16" dia. rivet	#11	
1/4" dia. rivet	F	

Rivet Code	D mm inch nom	Hole Dia mm inch		L inch	Grip Range inch		F mm inch nom	H mm inch max	Typical Ultimate Strength	
		min	max		min.	max.			Shear N lbs	Tensile N lbs
ATC42S				0.354	0.063	0.126				
ATC43S				0.417	0.126	0.189				
ATC44S	3.2	3.4	3.5	0.480	0.189	0.252	5.60	1.05	800	720
ATC45S	1/8	.134	.138	0.539	0.252	0.312	.220	.041	180	160
ATC46S				0.602	0.312	0.375				
ATC47S				0.665	0.375	0.437				
ATC52S				0.374	0.063	0.126				
ATC53S				0.437	0.126	0.189				
ATC54S				0.500	0.189	0.252				
ATC55S	4.0	4.2	4.3	0.559	0.252	0.312	7.15	1.30	1270	1160
ATC56S	5/32	.166	.170	0.622	0.312	0.375	.281	.051	285	260
ATC57S				0.685	0.375	0.437				
ATC58S				0.748	0.437	0.500				
ATC59S				0.811	0.500	0.563				
ATC62S				0.394	0.063	0.126				
ATC63S				0.457	0.126	0.189				
ATC64S				0.520	0.189	0.252				
ATC65S				0.579	0.252	0.312				
ATC66S				0.642	0.312	0.375				
ATC67S	4.8	5.0	5.1	0.705	0.375	0.437	8.85	1.55	1870	1610
ATC68S	3/16	.197	.201	0.768	0.437	0.500	.348	.061	420	360
ATC69S				0.831	0.500	0.563				
ATC610S				0.894	0.563	0.625				
ATC611S				0.957	0.625	0.688				
ATC612S				1.020	0.688	0.752				

**ALUMINUM BODY  
ALUMINUM MANDREL**

**ISO 9001 Certified  
Made according to IFI Specifications**

Material  
Body 5056 (AlMg5)  
Mandrel Aluminum Alloy

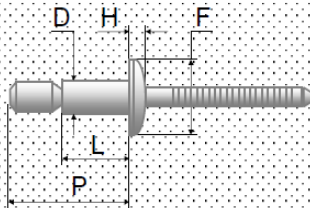

Rivet Code	D mm inch nom	Hole Dia mm inch		L inch	P inch	Grip Range inch		F mm inch nom	H mm inch max	Typical Ultimate Strength	
		min	max			min.	max.			Shear N lbs	Tensile N lbs
GPXA67	.188	.197	.205	0.571	0.965	0.063	0.437	.375	.091	495	450
GPXA86	6.4	6.7	6.9	0.571	1.016	0.079	0.374	12.70	2.90	4200	3692
GPXA810	.252	.264	.272	0.807	1.362	0.079	0.626	.500	.114	890	830

Finishes  
Body Polished  
Mandrel Polished

**Recommended Drill Size**  
3/16" dia. rivets #10  
1/4" dia. rivets G

**STEEL BODY  
STEEL MANDREL**

**ISO 9001 Certified  
Made according to IFI Specifications**

Material  
Body Carbon Steel  
Material Carbon Steel

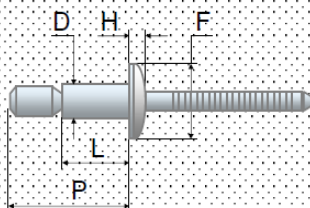

Rivet Code	D mm inch nom	Hole Dia mm inch		L inch	P inch	Grip Range inch		F mm inch nom	H mm inch max	Typical Ultimate Strength	
		min	max			min.	max.			Shear N lbs	Tensile N lbs
GPXS67	.188	.197	.205	0.571	0.965	0.063	0.437	.375	.091	1300	1000
GPXS86	6.4	6.7	6.9	0.571	1.016	0.079	0.374	12.70	2.90	10675	8229
GPXS810	.252	.264	.272	0.807	1.362	0.079	0.626	.500	.114	2400	1850

Finishes  
Body Zinc Plating  
Mandrel Zinc Plating

**Recommended Drill Size**  
3/16" dia. rivets #10  
1/4" dia. rivets G

**STAINLESS STEEL BODY  
STAINLESS STEEL MANDREL**

**ISO 9001 Certified  
Made according to IFI Specifications**

Material  
Body Stainless Steel  
Material Stainless Steel

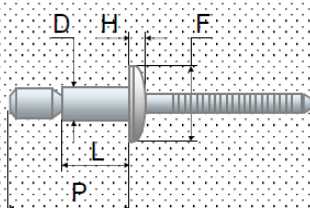

Rivet Code	D mm inch nom	Hole Dia mm inch		L inch	P inch	Grip Range inch		F mm inch nom	H mm inch max	Typical Ultimate Strength	
		min	max			min.	max.			Shear N lbs	Tensile N lbs
GPXSS67	.188	.197	.205	0.571	0.965	0.063	0.437	.375	.090	1300	1000
GPXSS86	6.4	6.7	6.9	0.571	1.016	0.079	0.374	12.70	2.97	10675	8229
GPXSS810	.252	.264	.272	0.807	1.362	0.079	0.626	.500	.117	2400	1850

**ALUMINUM BODY  
ALUMINUM MANDREL**

**ISO 9001 Certified  
Made according to IFI Specifications**

Material  
Body 5052/5154  
(AlMg2.5/3.5)  
Mandrel Aluminum Alloy

Rivet Code	D mm inch nom	Hole Dia mm inch		L inch	Grip Range inch		F mm inch nom	H mm inch max	Typical Ultimate Strength	
		min	max		min.	max.			Shear N lbs	Tensile N lbs
AX52A	4.0	4.2	4.4	0.535	0.039	0.118	7.95	1.50	600	800
AX54A	5/32	.165	.173	0.740	0.039	0.276	.312	.059	135	180
AX62A				0.602	0.039	0.157				
AX65A	4.8 3/16	5.0 .197	5.2 .205	0.807	0.039	0.354	9.50 .375	1.80 .071	800 180	1100 248
AX66A				0.965	0.157	0.472				

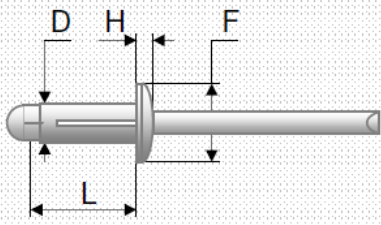

Finishes  
Body Polished  
Mandrel Polished

**ALUMINUM BODY  
ALUMINUM MANDREL**

**ISO 9001 Certified  
Made according to IFI Specifications**

Material  
Body 5052/5154  
(AlMg2.5/3.5)  
Mandrel Aluminum Alloy

Rivet Code	D mm inch nom	Hole Dia mm inch		L inch	Grip Range inch		F mm inch nom	H mm inch max	Typical Ultimate Strength	
		min	max		min.	max.			Shear N lbs	Tensile N lbs
AXL52A	4.0	4.2	4.4	0.535	0.039	0.118	11.90	1.90	600	800
AXL54A	5/32	.165	.173	0.740	0.039	0.276	.468	.075	135	180
AXL62A				0.602	0.039	0.157				
AXL65A	4.8 3/16	5.0 .197	5.2 .205	0.807	0.039	0.354	15.90 .625	2.35 .092	800 180	1100 248
AXL66A				0.965	0.157	0.472				

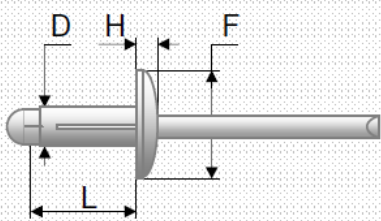

Finishes  
Body Polished  
Mandrel Polished

Recommended Drill/Hole Size		
1/8"	dia. rivet	#30
5/32"	dia. rivet	#20
3/16"	dia. rivet	#11
1/4"	dia. rivet	F